

Martin

1½ Drive Power/Impact

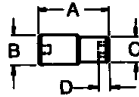

TYPE I

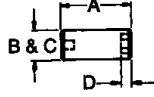

TYPE II

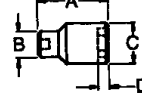

TYPE III



1½ Drive 6 Point Standard

Opening	Type	Length	Drive End	Opening End	Minimum Depth	Wt. Ea. Lbs.	Industrial Black	Std. Pkg. Qty.	Opening
		A	B	C	D		Part No.		
1½	I	3½	3¼	2½	¾	5.70	8644	1	1½
1⅞	I	3½	3¼	2½	¾	5.70	8646	1	1⅞
1½	I	3½	3¼	2½	¾	5.70	8648	1	1½
1⅞	I	3½	3¼	2½	¾	5.70	8650	1	1⅞
1½	I	3⅞	3¼	3	¾	5.70	8652	1	1½
1⅞	I	3⅞	3¼	3	¾	5.70	8654	1	1⅞
1½	I	3½	3¼	2½	¾	5.70	8656	1	1½
1⅞	I	3½	3¼	2½	¾	5.70	8658	1	1⅞
1½	I	3½	3¼	2½	¾	5.70	8660	1	1½
1⅞	I	3½	3¼	2½	¾	5.70	8662	1	1⅞
2	II	3½	3¼	3¼	1⅞	5.70	8664	1	2
2⅞	II	3½	3¼	3¼	1⅞	5.70	8666	1	2⅞
2½	III	3½	3¼	3½	1⅞	6.30	8668	1	2½
2⅞	III	3½	3¼	3½	1⅞	6.40	8670	1	2⅞
2½	III	3½	3¼	3½	1⅞	6.80	8672	1	2½
2⅞	III	3½	3¼	3½	1⅞	7.20	8674	1	2⅞
2½	III	3½	3¼	3½	1⅞	7.60	8676	1	2½
2⅞	III	3½	3¼	3½	1⅞	7.90	8678	1	2⅞
2½	III	4	3¼	3½	1⅞	8.20	8680	1	2½
2⅞	III	4	3¼	4	1⅞	8.50	8682	1	2⅞
2½	III	4½	3¼	4	1⅞	8.80	8684	1	2½
2⅞	III	4½	3¼	4	1⅞	8.90	8686	1	2⅞
2½	III	4½	3¼	4	1⅞	9.10	8688	1	2½
2⅞	III	4½	3¼	4	1⅞	9.30	8690	1	2⅞
2½	III	4½	3¼	4	1⅞	9.50	8692	1	2½
2⅞	III	4½	3¼	4½	1⅞	9.80	8694	1	2⅞
3	III	4½	3¼	4½	1⅞	9.90	8696	1	3
3⅞	III	4½	3¼	4½	1⅞	12.70	8698	1	3⅞
3½	III	4½	3¼	4½	1⅞	12.70	86100	1	3½
3⅞	III	4⅞	3¼	4½	1⅞	12.50	86102	1	3⅞
3½	III	4⅞	3¼	5	1⅞	14.00	86104	1	3½
3⅞	III	4⅞	3¼	5	1⅞	13.70	86106	1	3⅞
3½	III	4⅞	3¼	5	1⅞	13.40	86108	1	3½
3⅞	III	4½	3¼	5	1⅞	13.50	86110	1	3⅞
3½	III	4½	3¼	5½	1⅞	13.90	86112	1	3½
3⅞	III	5	3¼	5½	1⅞	14.40	86114	1	3⅞
3½	III	5	3¼	5½	1⅞	15.00	86116	1	3½
3⅞	III	5	3¼	5½	1⅞	14.70	86118	1	3⅞
3½	III	5	3¼	5½	1⅞	14.70	86120	1	3½
3⅞	III	5½	3¼	5½	1⅞	16.00	86122	1	3⅞
3½	III	5½	3¼	5½	1⅞	15.50	86124	1	3½
3⅞	III	5½	3¼	5½	1⅞	18.40	86126	1	3⅞
4	III	5½	3¼	5½	1⅞	18.00	86128	1	4
4⅞	III	5½	3¼	5½	1⅞	17.50	86130	1	4⅞
4½	III	5½	3¼	6	1⅞	20.20	86132	1	4½
4⅞	III	5½	3¼	6	1⅞	19.70	86134	1	4⅞
4½	III	5½	3¼	6	1⅞	19.20	86136	1	4½
4⅞	III	5½	3¼	6½	1⅞	22.00	86138	1	4⅞
4½	III	5½	3¼	6½	1⅞	21.60	86140	1	4½
4⅞	III	5½	3¼	6½	1⅞	21.00	86142	1	4⅞
4½	III	6	3¼	6½	1⅞	23.60	86144	1	4½
4½	III	6	3¼	6½	1⅞	23.60	86148	1	4½
4½	III	6	3¼	6½	1⅞	22.50	86152	1	4½

1½ Attachments

1½ DRIVE ATTACHMENTS	Item	Description	Wt. Ea. Lbs.	Industrial Black	Std. Pkg. Qty.
				Part No.	
	Adaptor	1½ F × 1M	3.40	87A	1
	Extension	8 Extension	8.80	8108	1
	Extension	12 Extension	12.10	8112	1
	Extension	15 Extension	14.40	8115	1
	Retainer Ring	For 8644 thru 86150 & 87A	.04	84576	1