

*Martin*



# Double Single SPROCKETS

Stock Bore • Taper Bushed • MST

**No. 40**  
**1/2" Pitch**

**All Steel**  
**Stock Sprockets**

*Martin*



**Double Single-Type A — Steel**

No. Teeth	Catalog Number	Diameters		Type	Min. Bore	Max. Bore	Dimensions				Wt. (Approx.)
		Outside Diameter	Pitch Diameter				L	C	E	w Nom.	
15	DS40A15	2.650	2.405	A	1/2	1 1/4	1 13/32	1 1/8	1 13/16	.284	1.2
16	DS40A16	2.810	2.563	A	1/2	1 1/4	1 13/32	1 1/8	2	.284	1.4
17	DS40A17	2.980	2.721	A	1/2	1 5/16	1 13/32	1 1/8	2 1/8	.284	1.6
18	DS40A18	3.140	2.879	A	1/2	1 1/2	1 13/32	1 1/8	2 5/16	.284	1.8
19	DS40A19	3.300	3.038	A	5/8	1 7/16	1 13/32	1 1/8	2 1/2	.284	2.2
20	DS40A20	3.460	3.196	A	5/8	1 3/4	1 13/32	1 1/8	2 3/8	.284	2.6
21	DS40A21	3.620	3.355	A	5/8	1 3/4	1 13/32	1 1/8	2 5/8	.284	2.9
22	DS40A22	3.780	3.513	A	5/8	1 9/16	1 13/32	1 1/8	2 9/16	.284	3.0
23	DS40A23	3.940	3.672	A	5/8	2 1/16	1 13/32	1 1/8	3 1/8	.284	3.5
24	DS40A24	4.100	3.831	A	5/8	2 1/4	1 13/32	1 1/8	3 3/4	.284	4.0
25	DS40A25	4.260	3.989	A	5/8	2 1/2	1 13/32	1 1/8	3 7/16	.284	4.5

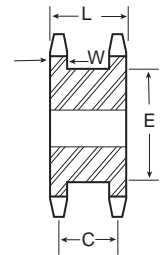

**TYPE A**

**Double Single-Taper Bushed — Steel**

No. Teeth	Catalog Number	Bushing Size	Diameters		Min. Bore	Max. Bore	Type	Dimensions				Wt. Rim Only	
			Outside Diameter	Pitch Diameter				L <sub>1</sub>	C	E	L <sub>2</sub>		w Nom.
18	DS40ATB18H	1215	3.140	2.879	1/2	1 1/4	A	1 13/32	1 1/8	2 5/16	1 1/2	.284	1.0
19	DS40ATB19H	1215	3.300	3.038	1/2	1 1/4	A	1 13/32	1 1/8	2 1/2	1 1/2	.284	1.1
20	DS40ATB20H	1215	3.460	3.196	1/2	1 1/4	A	1 13/32	1 1/8	2 3/8	1 1/2	.284	1.3
21	DS40ATB21H	1615	3.620	3.355	1/2	1 1/2	A	1 13/32	1 1/8	2 5/8	1 1/2	.284	1.3
23	DS40ATB23H	1615	3.940	3.672	1/2	1 1/2	A	1 13/32	1 1/8	3 3/8	1 1/2	.284	1.5
24	DS40ATB24H	1615	4.100	3.831	1/2	1 3/4	A	1 13/32	1 1/8	3 7/8	1 1/2	.284	1.7

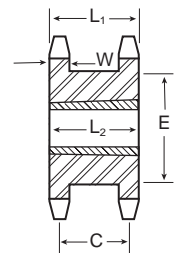

**TAPER BUSH TYPE A**

**Double Single - MST — Steel**

No. Teeth	Catalog Number	Bushing Size	Diameters		Min. Bore	Max. Bore	Type	Dimensions				Wt. Rim Only	
			Outside Diameter	Pitch Diameter				L <sub>1</sub>	C	E	L <sub>2</sub>		w Nom.
19	DS40H19H	H	3.300	3.038	5/8	1 1/2	BH	1 13/32	1 1/8	2 1/2	2 1/2	.284	1.5
21	DS40H21H	H	3.620	3.355	5/8	1 1/2	BH	1 13/32	1 1/8	2 5/8	2 1/2	.284	2
23	DS40P23H	P1	3.940	3.672	1/2	1 3/4	B	1 13/32	1 1/8	3 3/8	2 1/2	.284	2.3
24	DS40P24H	P1	4.100	3.831	1/2	1 3/4	B	1 13/32	1 1/8	3 7/8	2 1/2	.284	2.5

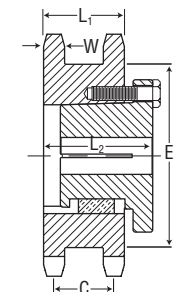

**MST TYPE B**

Call *Martin* for Same Day / Next Day Rebores



### Double Single-Type A — Steel

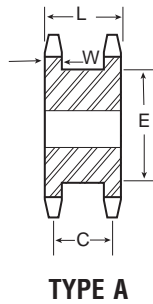

No. Teeth	Catalog Number	Diameters		Type	Min. Bore	Max. Bore	Dimensions				Wt. (Approx.)
		Outside Diameter	Pitch Diameter				L	C	E	w Nom.	
15	DS50A15	3.320	3.006	A	5/8	1 1/2	1 23/32	1 1/16	2 3/8	.343	2.1
16	DS50A16	3.520	3.204	A	5/8	1 11/16	1 23/32	1 1/16	2 31/64	.343	2.4
17	DS50A17	3.720	3.401	A	5/8	1 3/4	1 23/32	1 1/16	2 11/16	.343	2.9
18	DS50A18	3.920	3.599	A	5/8	1 5/8	1 23/32	1 1/16	2 7/64	.343	3.3
19	DS50A19	4.120	3.797	A	5/8	2 1/16	1 23/32	1 1/16	3 3/64	.343	3.7
20	DS50A20	4.320	3.995	A	5/8	2 1/4	1 23/32	1 1/16	3 3/32	.343	4.2
21	DS50A21	4.520	4.194	A	5/8	2 1/2	1 23/32	1 1/16	3 31/64	.343	4.8
22	DS50A22	4.720	4.392	A	5/8	2 5/8	1 23/32	1 1/16	3 11/16	.343	5.3
23	DS50A23	4.920	4.590	A	5/8	3 1/8	1 23/32	1 1/16	3 5/64	.343	5.8
24	DS50A24	5.120	4.788	A	5/8	3 1/4	1 23/32	1 1/16	4 1/64	.343	6.3

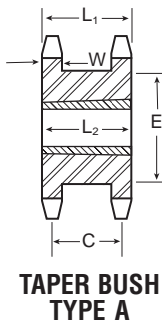

### Double Single-Taper Bushed — Steel

No. Teeth	Catalog Number	Bushing Size	Diameters		Min. Bore	Max. Bore	Type	Dimensions				Wt. Rim Only	
			Outside Diameter	Pitch Diameter				L1	C	E	L2		w Nom.
16	DS50ATB16H	1215	3.520	3.204	1/2	1 1/8	A	1 23/32	1 1/16	2 31/64	1 1/2	.343	3.0
17	DS50ATB17H	1615	3.720	3.401	1/2	1 1/8	A	1 23/32	1 1/16	2 11/16	1 1/2	.343	1.8
18	DS50ATB18H	1615	3.920	3.599	1/2	1 1/8	A	1 23/32	1 1/16	2 5/64	1 1/2	.343	2.2
19	DS50ATB19H	1615	4.120	3.797	1/2	1 1/8	A	1 23/32	1 1/16	3 3/64	1 1/2	.343	2.7
20	DS50ATB20H	1615	4.320	3.995	1/2	1 1/8	A	1 23/32	1 1/16	3 3/32	1 1/2	.343	5.0
21	DS50ATB21H	2012	4.520	4.194	1/2	2	A	1 23/32	1 1/16	3 31/64	1 1/4	.343	3.3
23	DS50ATB23H	2012	4.920	4.590	1/2	2	A	1 23/32	1 1/16	3 7/64	1 1/4	.343	3.7
24	DS50ATB24H	2012	5.120	4.788	1/2	2	A	1 23/32	1 1/16	4 1/64	1 1/4	.343	4.1

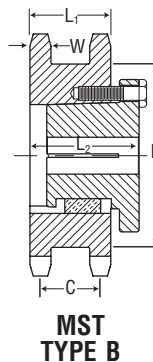

### Double Single-MST — Steel

No. Teeth	Catalog Number	Bushing Size	Diameters		Min. Bore	Max. Bore	Type	Dimensions				Wt. Rim Only	
			Outside Diameter	Pitch Diameter				L1	C	E	L2		w Nom.
17	DS50H17H	H	3.720	3.401	3/8	1 1/2	BH	1 23/32	1 1/16	2 11/16	2 3/32	.343	2.3
19	DS50P19H	P1	4.120	3.797	1/2	1 3/4	B	1 23/32	1 1/16	3 3/64	2 11/32	.343	2.8
21	DS50P21H	P1	4.520	4.194	1/2	1 3/4	B	1 23/32	1 1/16	3 31/64	2 11/32	.343	3.8
23	DS50P23H	P1	4.920	4.590	1/2	1 3/4	B	1 23/32	1 1/16	3 5/64	2 11/32	.343	4.6
24	DS50P24H	P1	5.120	4.788	1/2	1 3/4	B	1 23/32	1 1/16	4 1/64	2 11/32	.343	5

Also available with Hex Bore, Ball Bearing Bore, Bronze Bushed, etc. call *Martin*.

No. 60  
3/4" Pitch

All Steel  
Stock Sprockets

*Martin*



**Double Single-Type A — Steel**

No. Teeth	Catalog Number	Diameters		Type	Min. Bore	Max. Bore	Dimensions				Wt. (Approx.)
		Outside Diameter	Pitch Diameter				L	C	E	w Nom.	
13	DS60A13	3.490	3.134	A	3/8	1 1/8	1 1/16	1 3/64	2 1/2	.459	2.6
14	DS60A14	3.740	3.371	A	3/8	1 1/8	1 1/16	1 3/64	2 1/2	.459	3.2
15	DS60A15	3.980	3.607	A	3/8	1 1/2	1 1/16	1 3/64	2 5/8	.459	3.8
16	DS60A16	4.220	3.844	A	3/8	1 1/8	1 1/16	1 3/64	2 5/8	.459	4.5
17	DS60A17	4.460	4.082	A	3/8	1 3/8	1 1/16	1 3/64	3 1/2	.459	5.3
18	DS60A18	4.700	4.319	A	3/8	1 1/2	1 1/16	1 3/64	3 15/32	.459	6.5
19	DS60A19	4.950	4.557	A	3/8	2 1/8	1 1/16	1 3/64	3 5/8	.459	6.8
20	DS60A20	5.190	4.794	A	3/8	2 1/4	1 1/16	1 3/64	3 5/8	.459	7.0
21	DS60A21	5.430	5.032	A	3/8	2 3/8	1 1/16	1 3/64	4 1/8	.459	7.5
22	DS60A22	5.670	5.270	A	3/8	2 3/4	1 1/16	1 3/64	4 27/64	.459	11.0
23	DS60A23	5.910	5.508	A	3/8	2 3/4	1 1/16	1 3/64	4 9/16	.459	11.5
24	DS60A24	6.150	5.749	A	3/8	2 3/4	1 1/16	1 3/64	4 29/32	.459	12.0

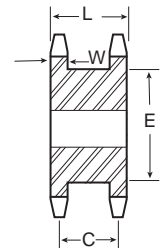

TYPE A

**Double Single-Taper Bushed — Steel**

No. Teeth	Catalog Number	Bushing Size	Diameters		Min. Bore	Max. Bore	Type	Dimensions				Wt. Rim Only	
			Outside Diameter	Pitch Diameter				L <sub>1</sub>	C	E	L <sub>2</sub>		w Nom.
16	DS60ATB16H	1615	4.220	3.844	3/8	1 1/8	A	1 1/16	1 3/64	2 5/8	1 1/2	.459	4.5
17	DS60ATB17H	1615	4.460	4.002	3/8	1 1/8	A	1 1/16	1 3/64	3 1/2	1 1/2	.459	4.5
18	DS60ATB18H	2012	4.700	4.319	3/8	2	A	1 1/16	1 3/64	3 15/32	1 1/4	.459	5.0
19	DS60ATB19H	2012	4.950	4.557	3/8	2	A	1 1/16	1 3/64	3 5/8	1 1/4	.459	5.8
20	DS60ATB20H	2517	5.190	4.794	3/8	2 1/8	A	1 1/16	1 3/64	3 5/8	1 1/4	.459	5.6
21	DS60ATB21H	2517	5.430	5.032	3/8	2 1/8	A	1 1/16	1 3/64	4 1/8	1 1/4	.459	6.4
23	DS60ATB23H	2517	5.910	5.508	3/8	2 3/8	A	1 1/16	1 3/64	4 9/16	1 1/4	.459	7.3
24	DS60ATB24H	2517	6.150	5.746	3/8	2 3/8	A	1 1/16	1 3/64	4 29/32	1 1/4	.459	8.2

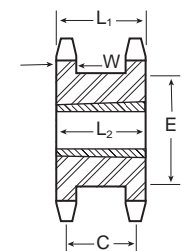

TAPER BUSH TYPE A

**Double Single-MST — Steel**

No. Teeth	Catalog Number	Bushing Size	Diameters		Min. Bore	Max. Bore	Type	Dimensions				Wt. Rim Only	
			Outside Diameter	Pitch Diameter				L <sub>1</sub>	C	E	L <sub>2</sub>		w Nom.
17	DS60P17H	P1	4.460	4.002	3/8	1 1/8	B	1 1/16	1 3/64	3 1/2	1 15/16	.459	3.9
19	DS60P19H	P1	4.950	4.557	3/8	1 1/8	B	1 1/16	1 3/64	3 5/8	1 15/16	.459	5.3
21	DS60Q21H	Q1	5.430	5.032	3/8	2 1/8	B	1 1/16	1 3/64	4 1/8	2 1/2	.459	5.4
22	DS60Q22H	Q1	5.670	5.270	3/8	2 11/16	B	1 1/16	1 3/64	4 27/64	2 1/2	.459	6.2
23	DS60Q23H	Q1	5.910	5.508	3/8	2 11/16	B	1 1/16	1 3/64	4 49/64	2 1/2	.459	6.9
24	DS60Q24H	Q1	6.150	5.746	3/8	2 11/16	B	1 1/16	1 3/64	4 29/32	2 1/2	.459	7.6

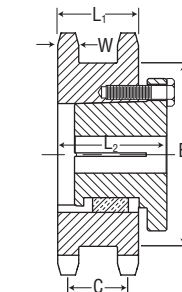

MST TYPE B

Call *Martin* for Same Day / Next Day Rebores



### Double Single-Type A — Steel

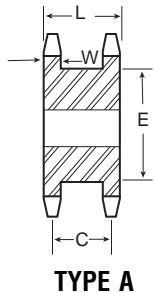

No. Teeth	Catalog Number	Diameters		Type	Min. Bore	Max. Bore	Dimensions				Wt. (Approx)
		Outside Diameter	Pitch Diameter				L	C	E	w Nom.	
13	DS80A13	4.660	4.179	A	1	2	2 <sup>3</sup> / <sub>16</sub>	1 <sup>1</sup> / <sub>2</sub>	3 <sup>1</sup> / <sub>4</sub>	.575	6.5
14	DS80A14	4.980	4.494	A	1	2 <sup>1</sup> / <sub>2</sub>	2 <sup>3</sup> / <sub>16</sub>	1 <sup>1</sup> / <sub>2</sub>	3 <sup>1</sup> / <sub>2</sub>	.575	7.7
15	DS80A15	5.300	4.810	A	1	2 <sup>3</sup> / <sub>16</sub>	2 <sup>3</sup> / <sub>16</sub>	1 <sup>1</sup> / <sub>2</sub>	3 <sup>3</sup> / <sub>16</sub>	.575	9.1
16	DS80A16	5.630	5.126	A	1	2 <sup>1</sup> / <sub>2</sub>	2 <sup>3</sup> / <sub>16</sub>	1 <sup>1</sup> / <sub>2</sub>	4	.575	9.5
17	DS80A17	5.950	5.442	A	1	2 <sup>3</sup> / <sub>16</sub>	2 <sup>3</sup> / <sub>16</sub>	1 <sup>1</sup> / <sub>2</sub>	4 <sup>1</sup> / <sub>16</sub>	.575	10.8
18	DS80A18	6.270	5.759	A	1	3 <sup>1</sup> / <sub>2</sub>	2 <sup>3</sup> / <sub>16</sub>	1 <sup>1</sup> / <sub>2</sub>	4 <sup>1</sup> / <sub>16</sub>	.575	12.1
19	DS80A19	6.590	6.076	A	1	3 <sup>1</sup> / <sub>2</sub>	2 <sup>3</sup> / <sub>16</sub>	1 <sup>1</sup> / <sub>2</sub>	4 <sup>3</sup> / <sub>16</sub>	.575	12.8
20	DS80A20	6.910	6.392	A	1	3 <sup>1</sup> / <sub>2</sub>	2 <sup>3</sup> / <sub>16</sub>	1 <sup>1</sup> / <sub>2</sub>	5 <sup>1</sup> / <sub>2</sub>	.575	14.0
21	DS80A21	7.240	6.710	A	1	3 <sup>1</sup> / <sub>2</sub>	2 <sup>3</sup> / <sub>16</sub>	1 <sup>1</sup> / <sub>2</sub>	5 <sup>3</sup> / <sub>2</sub>	.575	16.5
22	DS80A22	7.560	7.027	A	1	3 <sup>1</sup> / <sub>2</sub>	2 <sup>3</sup> / <sub>16</sub>	1 <sup>1</sup> / <sub>2</sub>	5 <sup>9</sup> / <sub>16</sub>	.575	18.4
23	DS80A23	7.880	7.344	A	1	3 <sup>1</sup> / <sub>2</sub>	2 <sup>3</sup> / <sub>16</sub>	1 <sup>1</sup> / <sub>2</sub>	6 <sup>1</sup> / <sub>16</sub>	.575	20.5

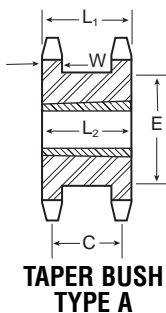

### Double Single-Taper Bushed — Steel

No. Teeth	Catalog Number	Bushing Size	Diameters		Min. Bore	Max. Bore	Type	Dimensions				Wt. Rim Only	
			Outside Diameter	Pitch Diameter				L <sub>1</sub>	C	E	L <sub>2</sub>		w Nom.
17	DS80ATB17H	2517	5.950	5.442	1/2	2 1/2	A	2 3/16	1 1/2	4 1/16	1 3/4	.575	7.6
18	DS80ATB18H	2517	6.270	5.759	1/2	2 1/2	A	2 3/16	1 1/2	4 1/16	1 3/4	.575	8.7
19	DS80ATB19H	3020	6.590	6.076	15/16	3	A	2 3/16	1 1/2	4 3/16	2	.575	9.7
20	DS80ATB20H	3020	6.910	6.392	15/16	3	A	2 3/16	1 1/2	5 1/2	2	.575	10.
21	DS80ATB21H	3020	7.240	6.710	15/16	3	A	2 3/16	1 1/2	5 9/16	2	.575	12.
22	DS80ATB22H	3020	7.560	7.027	15/16	3	A	2 3/16	1 1/2	5 3/4	2	.575	13.0
23	DS80ATB23H	3020	7.880	7.344	15/16	3	A	2 3/16	1 1/2	6 1/4	2	.575	14.5

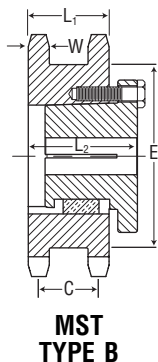

### Double Single- MST — Steel

No. Teeth	Catalog Number	Bushing Size	Diameters		Min. Bore	Max. Bore	Type	Dimensions				Wt. Rim Only	
			Outside Diameter	Pitch Diameter				L <sub>1</sub>	C	E	L <sub>2</sub>		w Nom.
17	DS80Q17H	Q1	5.950	5.442	3/4	2 1/16	B	2 3/16	1 1/2	4 1/16	3 1/16	.575	7.2
19	DS80Q19H	Q1	6.590	6.076	3/4	2 1/16	B	2 3/16	1 1/2	4 3/16	3 1/16	.575	10.5
20	DS80Q20H	Q1	6.910	6.392	3/4	2 1/16	B	2 3/16	1 1/2	5 1/2	3 1/16	.575	12.2
21	DS80R21H	R1	7.240	6.710	1 1/8	3 3/8	B	2 3/16	1 1/2	5 9/16	3 3/16	.575	12.8
23	DS80R23H	R1	7.880	7.344	1 1/8	3 3/8	B	2 3/16	1 1/2	6 1/4	3 3/16	.575	13.3

Also available with Hex Bore, Ball Bearing Bore, Bronze Bushed, etc. call *Martin*.



### Double Single-Type A — Steel

No. Teeth	Catalog Number	Diameters		Type	Min. Bore	Max. Bore	Dimensions				Wt. (Approx.)
		Outside Diameter	Pitch Diameter				L	C	E	w Nom.	
13	DS100A13	5.820	5.223	A	1	2½	2 <sup>11</sup> / <sub>16</sub>	2	4 <sup>19</sup> / <sub>32</sub>	.692	11.2
14	DS100A14	6.230	5.617	A	1¼	2¾	2 <sup>11</sup> / <sub>16</sub>	2	4 <sup>3</sup> / <sub>16</sub>	.692	13.5
15	DS100A15	6.630	6.012	A	1¼	3 <sup>1</sup> / <sub>16</sub>	2 <sup>11</sup> / <sub>16</sub>	2	4 <sup>19</sup> / <sub>32</sub>	.692	16.8
16	DS100A16	7.030	6.407	A	1¼	3 <sup>3</sup> / <sub>16</sub>	2 <sup>11</sup> / <sub>16</sub>	2	5	.692	19.3
17	DS100A17	7.440	6.803	A	1¼	3 <sup>5</sup> / <sub>16</sub>	2 <sup>11</sup> / <sub>16</sub>	2	5 <sup>15</sup> / <sub>32</sub>	.692	21.5
18	DS100A18	7.840	7.198	A	1¼	3¾	2 <sup>11</sup> / <sub>16</sub>	2	5 <sup>5</sup> / <sub>16</sub>	.692	23.0
19	DS100A19	8.240	7.595	A	1¼	4 <sup>1</sup> / <sub>16</sub>	2 <sup>11</sup> / <sub>16</sub>	2	6 <sup>3</sup> / <sub>16</sub>	.692	25.0
20	DS100A20	8.640	7.991	A	1¼	4 <sup>3</sup> / <sub>16</sub>	2 <sup>11</sup> / <sub>16</sub>	2	6 <sup>3</sup> / <sub>16</sub>	.692	26.5
21	DS100A21	9.040	8.387	A	1¼	5¼	2 <sup>11</sup> / <sub>16</sub>	2	7	.692	29.0

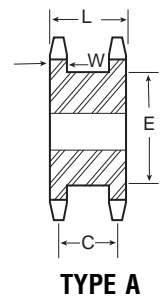

### Double Single-Taper Bushed — Steel

No. Teeth	Catalog Number	Bushing Size	Diameters		Min. Bore	Max. Bore	Type	Dimensions					Wt. Rim Only
			Outside Diameter	Pitch Diameter				L <sub>1</sub>	C	E	L <sub>2</sub>	w Nom.	
15	DS100ATB15H	2517	6.630	6.012	¾	2½	A	2 <sup>11</sup> / <sub>16</sub>	2	4 <sup>19</sup> / <sub>32</sub>	1¾	.692	12.5
16	DS100ATB16H	2517	7.030	6.407	¾	2½	A	2 <sup>11</sup> / <sub>16</sub>	2	5	1¾	.692	13.0
17	DS100ATB17H	3020	7.440	6.803	1 <sup>1</sup> / <sub>16</sub>	3	A	2 <sup>11</sup> / <sub>16</sub>	2	5 <sup>15</sup> / <sub>32</sub>	2	.692	14.0
18	DS100ATB18H	3020	7.840	7.198	1 <sup>1</sup> / <sub>16</sub>	3	A	2 <sup>11</sup> / <sub>16</sub>	2	5 <sup>5</sup> / <sub>16</sub>	2	.692	16.0
19	DS100ATB19H	3020	8.240	7.595	1 <sup>1</sup> / <sub>16</sub>	3	A	2 <sup>11</sup> / <sub>16</sub>	2	6 <sup>3</sup> / <sub>16</sub>	2	.692	20.0
20	DS100ATB20H	3020	8.640	7.991	1 <sup>1</sup> / <sub>16</sub>	3	A	2 <sup>11</sup> / <sub>16</sub>	2	6 <sup>3</sup> / <sub>16</sub>	1¾	.692	27.5
21	DS100ATB21H	3020	9.040	8.387	1 <sup>1</sup> / <sub>16</sub>	3	A	2 <sup>11</sup> / <sub>16</sub>	2	7	2	.692	27.5

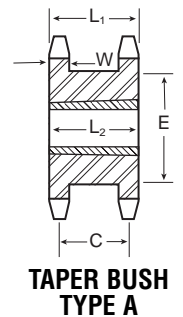

### Double Single- MST — Steel

No. Teeth	Catalog Number	Bushing Size	Diameters		Min. Bore	Max. Bore	Type	Dimensions					Wt. Rim Only
			Outside Diameter	Pitch Diameter				L <sub>1</sub>	C	E	L <sub>2</sub>	w Nom.	
17	DS100R17H	R1	7.440	6.803	1 <sup>1</sup> / <sub>8</sub>	3¾	B	2 <sup>11</sup> / <sub>16</sub>	2	5 <sup>15</sup> / <sub>32</sub>	3 <sup>27</sup> / <sub>32</sub>	.692	12.5
19	DS100R19H	R1	8.240	7.595	1 <sup>1</sup> / <sub>8</sub>	3¾	B	2 <sup>11</sup> / <sub>16</sub>	2	6 <sup>3</sup> / <sub>16</sub>	3 <sup>27</sup> / <sub>32</sub>	.692	18.8
21	DS100R21H	R1	9.040	8.387	1 <sup>1</sup> / <sub>8</sub>	3¾	B	2 <sup>11</sup> / <sub>16</sub>	2	7	3 <sup>27</sup> / <sub>32</sub>	.692	23.1

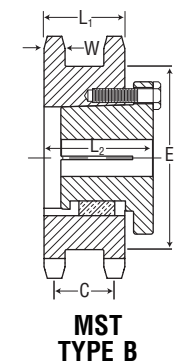

# Martin

## No. 120 No. 140 No. 160 1½" Pitch 1¾" Pitch 2" Pitch

**DS** **50** **ATB** **19** **H**      Hardened Tooth  
 Double Single Pitch      Hub Style      # of Teeth      (Blank unhardened)  
 ATB - Taper Bushed  
 P; Q etc. MST Bushed  
 A - Minimum Plain Bore



### 120 - 1-1/2" Pitch Double Single-Type A — Steel

No. Teeth	Catalog Number	Diameters		Type	Min. Bore	Max. Bore	Dimensions				Wt. (Approx.)
		Outside Diameter	Pitch Diameter				L	C	E	w Nom.	
15	DS120A15	7.960	7.215	A	1 <sup>1</sup> / <sub>16</sub>	3 <sup>3</sup> / <sub>4</sub>	3 <sup>3</sup> / <sub>16</sub>	2 <sup>1</sup> / <sub>4</sub>	5 <sup>33</sup> / <sub>64</sub>	.924	30.0
16	DS120A16	8.440	7.689	A	1 <sup>1</sup> / <sub>16</sub>	4	3 <sup>3</sup> / <sub>16</sub>	2 <sup>1</sup> / <sub>4</sub>	6	.924	34.0
17	DS120A17	8.920	8.163	A	1 <sup>1</sup> / <sub>16</sub>	4 <sup>1</sup> / <sub>16</sub>	3 <sup>3</sup> / <sub>16</sub>	2 <sup>1</sup> / <sub>4</sub>	6 <sup>31</sup> / <sub>64</sub>	.924	37.0
18	DS120A18	9.410	8.638	A	1 <sup>1</sup> / <sub>16</sub>	5 <sup>1</sup> / <sub>16</sub>	3 <sup>3</sup> / <sub>16</sub>	2 <sup>1</sup> / <sub>4</sub>	6 <sup>31</sup> / <sub>32</sub>	.924	42.0
19	DS120A19	9.890	9.113	A	1 <sup>1</sup> / <sub>16</sub>	5 <sup>1</sup> / <sub>2</sub>	3 <sup>3</sup> / <sub>16</sub>	2 <sup>1</sup> / <sub>4</sub>	7 <sup>29</sup> / <sub>64</sub>	.924	47.0
20	DS120A20	10.370	9.589	A	1 <sup>1</sup> / <sub>16</sub>	5 <sup>15</sup> / <sub>16</sub>	3 <sup>3</sup> / <sub>16</sub>	2 <sup>1</sup> / <sub>4</sub>	7 <sup>15</sup> / <sub>16</sub>	.924	51.0

### 140 - 1-3/4" Pitch Double Single-Type A — Steel

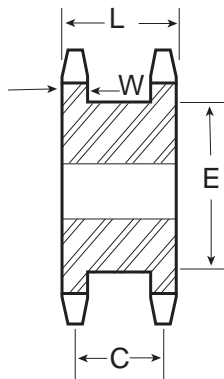

TYPE A

No. Teeth	Catalog Number	Diameters		Type	Min. Bore	Max. Bore	Dimensions				Wt. (Approx.)
		Outside Diameter	Pitch Diameter				L	C	E	w Nom.	
14	DS140A14	8.720	7.864	A	1 <sup>1</sup> / <sub>16</sub>	3 <sup>1</sup> / <sub>8</sub>	3 <sup>3</sup> / <sub>8</sub>	2 <sup>1</sup> / <sub>2</sub>	5 <sup>5</sup> / <sub>8</sub>	.924	35.0
15	DS140A15	9.280	8.417	A	1 <sup>1</sup> / <sub>16</sub>	4 <sup>1</sup> / <sub>16</sub>	3 <sup>3</sup> / <sub>8</sub>	2 <sup>1</sup> / <sub>2</sub>	6 <sup>29</sup> / <sub>64</sub>	.924	43.0
16	DS140A16	9.850	8.970	A	1 <sup>1</sup> / <sub>16</sub>	5 <sup>1</sup> / <sub>4</sub>	3 <sup>3</sup> / <sub>8</sub>	2 <sup>1</sup> / <sub>2</sub>	7 <sup>5</sup> / <sub>64</sub>	.924	49.0
17	DS140A17	10.410	9.524	A	1 <sup>1</sup> / <sub>16</sub>	5 <sup>5</sup> / <sub>16</sub>	3 <sup>3</sup> / <sub>8</sub>	2 <sup>1</sup> / <sub>2</sub>	7 <sup>37</sup> / <sub>64</sub>	.924	58.0
18	DS140A18	10.980	10.078	A	1 <sup>1</sup> / <sub>16</sub>	6 <sup>1</sup> / <sub>8</sub>	3 <sup>3</sup> / <sub>8</sub>	2 <sup>1</sup> / <sub>2</sub>	8 <sup>5</sup> / <sub>64</sub>	.924	66.0

### 160 - 2" Pitch Double Single-Type A — Steel

No. Teeth	Catalog Number	Diameters		Type	Min. Bore	Max. Bore	Dimensions				Wt. (Approx.)
		Outside Diameter	Pitch Diameter				L	C	E	w Nom.	
15	DS160A15	10.609	9.620	A	1 <sup>1</sup> / <sub>16</sub>	5 <sup>1</sup> / <sub>2</sub>	4 <sup>1</sup> / <sub>8</sub>	3	7 <sup>7</sup> / <sub>8</sub>	1.156	69.0
16	DS160A16	11.255	10.252	A	1 <sup>1</sup> / <sub>16</sub>	6	4 <sup>1</sup> / <sub>8</sub>	3	8 <sup>1</sup> / <sub>64</sub>	1.156	75.0
17	DS160A17	11.899	10.885	A	1 <sup>1</sup> / <sub>16</sub>	6 <sup>1</sup> / <sub>2</sub>	4 <sup>1</sup> / <sub>8</sub>	3	8 <sup>21</sup> / <sub>32</sub>	1.156	92.0
18	DS160A18	12.543	11.518	A	1 <sup>1</sup> / <sub>16</sub>	6 <sup>13</sup> / <sub>16</sub>	4 <sup>1</sup> / <sub>8</sub>	3	9 <sup>1</sup> / <sub>16</sub>	1.156	97.0

Also available: triple rows of teeth, duplex sprockets with different numbers of teeth, different pitches, etc. call *Martin*.

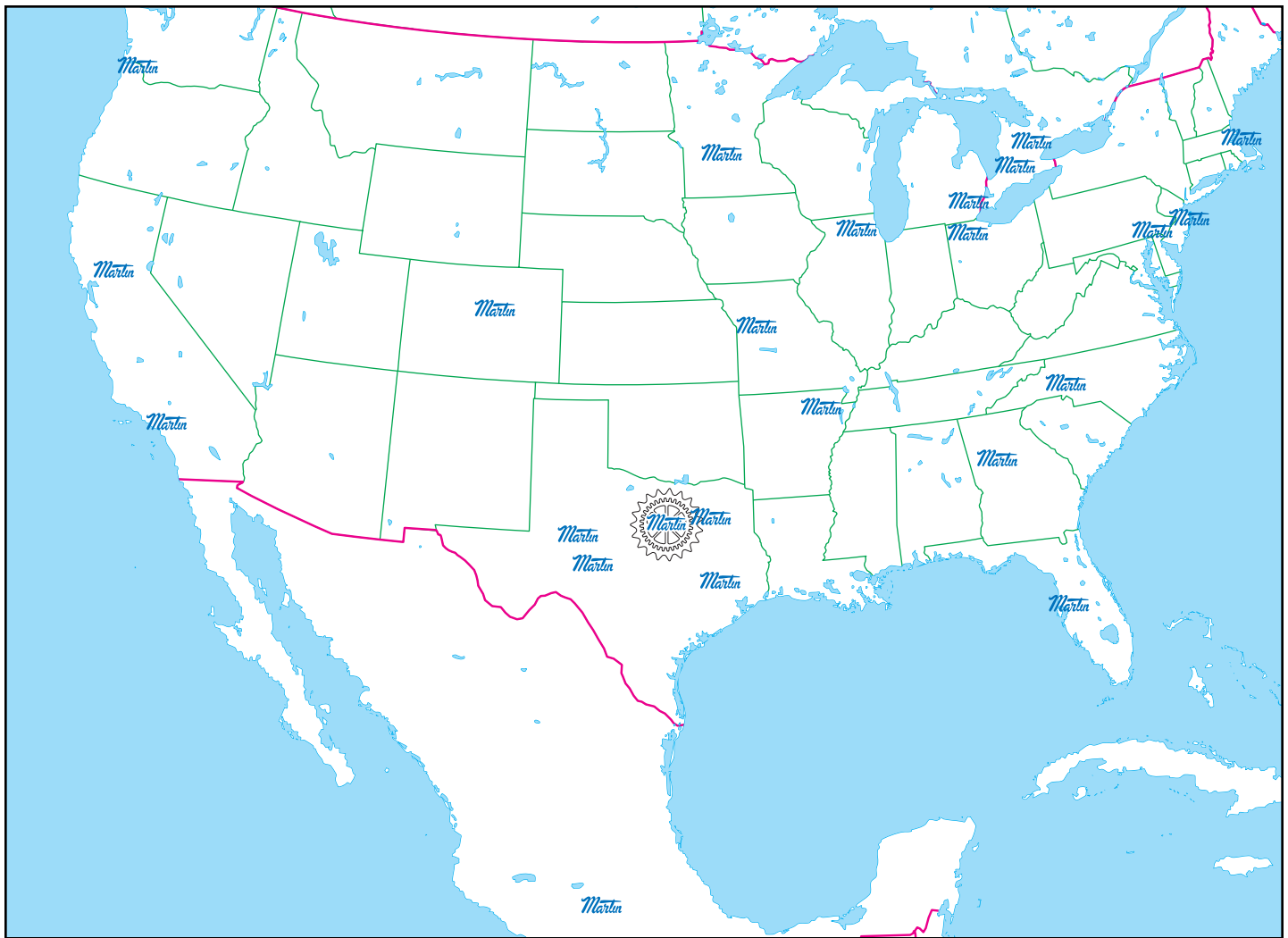

## USA

### General Offices

### Sales and Manufacturing

#### Arlington, TX

817-258-3000 (FAX 817-258-3333)

### Sales and Manufacturing

#### Danielsville, PA

610-837-1841 (FAX 610-837-7337)

#### Ft. Worth, TX (Conveyor Division)

817-258-3000 (FAX 817-258-3173)

#### Mansfield, TX

817-473-1520 (FAX 817-473-0465)

#### Montpelier, OH

419-485-5515 (FAX 419-485-3565)

#### Sacramento, CA

916-441-7172 (FAX 916-441-4600)

#### Scottsdale, GA

404-292-8744 (FAX 404-292-7771)

#### Ft. Worth, TX (Tool & Forge Division)

817-258-3000 (FAX 817-258-3173)

## Mini Manufacturing Centers

#### Boston, MA

508-634-3990 (FAX 508-634-3998)

#### Charlotte, NC

704-394-9111 (FAX 704-394-9122)

#### Chicago, IL

847-298-8844 (FAX 847-298-2967)

#### Denver, CO

303-371-8466 (FAX 303-371-7116)

#### Detroit, MI

734-367-0238 (FAX 734-367-0547)

#### Houston, TX

713-849-4330 (FAX 713-849-4807)

#### Kansas City, MO

816-231-5575 (FAX 816-231-1959)

#### Los Angeles, CA

323-728-8117 (FAX 323-722-7526)

#### Minneapolis, MN

952-829-0623 (FAX 952-944-9385)

#### Portland, OR

503-223-7261 (FAX 503-221-0203)

#### Tampa, FL

813-623-1705 (FAX 813-626-8953)

#### Wayne, NJ

973-633-5700 (FAX 973-633-7196)

### Manufacturing Only

#### Abilene, TX

#### Clarksville, TX

#### Dallas, TX

#### Paragould, AR (Includes the Plastics Div.)

## CANADA

### Sales and Manufacturing

#### *Martin* Sprocket & Gear Canada Inc.

Mississauga, Ontario, Canada L5T 1R9

905-670-1991 (FAX 905-670-2110)

#### *Martin* Sprocket & Gear Canada Inc.

#### (Conveyor Division)

Ayr, Ontario 519-621-0546 (FAX 519-621-4413)

## MEXICO

### Sales and Manufacturing

#### *Martin* Sprocket & Gear de Mexico,

#### S.A. de C.V.

01152722790023 (FAX 01152722790024)

*Martin*

**SPROCKET & GEAR, INC.** • 3100 SPROCKET DR. • ARLINGTON, TX 76015 • 817-258-3000 • www.martinsprocket.com

For more information, contact your nearest *Martin* Distributor or Service Center.