

BORED TO SIZE

METRIC FINISHED BORE



SPROCKETS

Martin Announces...

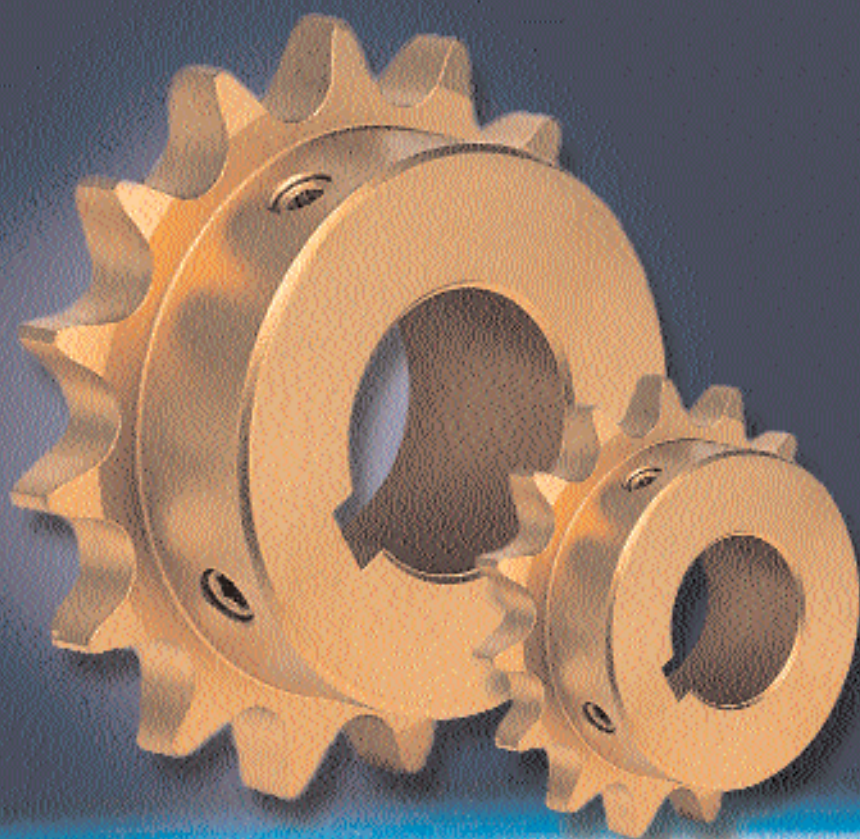

**the Very First
Metric
Finished Bore Sprockets
Available in Stock!**

CHAIN DATA:

BS 228/3

ISO 06B-1

PITCH: 9.525mm (0.375 IN.)

ROLLER DIAMETER: 6.35mm (0.250 IN.)

ROLLER WIDTH: 5.72mm (0.225 IN.)

TENSILE: 910 KILOS (2,000 LBS.)

#06B-1 CHAIN

9.525mm (3/8") PITCH

No. Teeth	Catalog Number	Outside Diameter (mm)	Length Thru Bore	Weight Kilos (App.)	Stock Finished Bores (mm) Includes Keyway and Setscrew
10	06BS10	30.82	22	.05	*10 ▼12 ▼14 ▼16
11	06BS11	33.80	25	.07	*10 ▼12 ▼14 16 19
12	06BS12	36.80	25	.08	*10 *12 14 16 19
13	06BS13	39.79	25	.09	*10 *12 14 16 19
14	06BS14	42.80	25	.10	*12 14 16 19
15	06BS15	45.81	25	.11	*12 14 16 19 20 22 24 25
16	06BS16	48.82	28	.13	*12 14 16 19 20 22 24 25
17	06BS17	51.83	28	.16	*12 14 16 19 20 22 24 25
18	06BS18	54.85	28	.18	*12 14 16 19 20 22 24 25
19	06BS19	57.87	28	.20	*12 14 16 19 20 22 24 25
20	06BS20	60.89	28	.23	*12 14 16 19 20 22 24 25
21	06BS21	63.91	28	.34	16 19 20 22 24 25
22	06BS22	66.93	28	.35	16 19 20 22 24 25
23	06BS23	69.95	28	.35	16 19 20 22 24 25
24	06BS24	72.97	28	.36	16 19 20 22 24 25
25	06BS25	76.00	28	.36	16 19 20 22 24 25

* Indicates no Keyway. (2) M6 Setscrews only in 12mm Bore & 14mm Bore.

▼ Keyway with Setscrew at 90.

Hub diameters vary to suit different Bore Sizes.

KEYWAY IS ON CENTER LINE OF TOOTH.

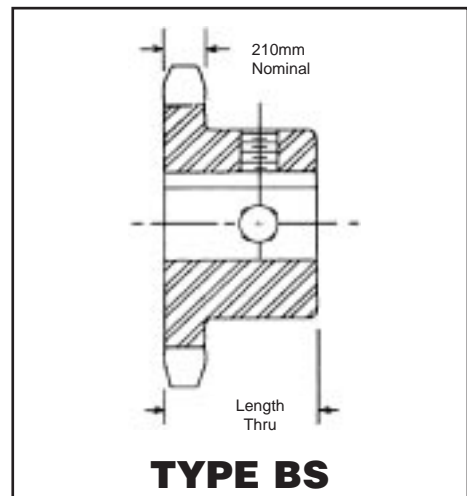

#08B

Stock Bored-to-Size



CHAIN DATA:

BS 228/7

ISO 08B-1

PITCH: 12.70mm (0.500 IN.)

ROLLER DIAMETER: 8.51mm (0.335 IN.)

ROLLER WIDTH: 7.75mm (0.305 IN.)

TENSILE: 1820 KILOS (4,000 LBS.)

#08B-1 CHAIN

12.70mm (1/2") PITCH

No. Teeth	Catalog Number	Outside Diameter (mm)	Length Thru Bore	Weight Kilos (App.)	Stock Finished Bores (mm) Includes Keyway and Setscrew
10	08BS10	41.10	25	0.11	*12 14 16 19
11	08BS11	45.07	25	0.13	*12 14 16 19 20 22
12	08BS12	49.07	28	0.15	*12 14 16 19 20 22 24 25 28
13	08BS13	53.06	28	0.20	*12 14 16 19 20 22 24 25 28
14	08BS14	57.07	28	0.23	*12 14 16 19 20 22 24 25 28
15	08BS15	61.09	28	0.24	*12 14 16 19 20 22 24 25 28 30 32
16	08BS16	65.10	28	0.30	16 19 20 22 24 25 28 30 32
17	08BS17	69.11	28	0.40	16 19 20 22 24 25 28 30 32
18	08BS18	73.14	28	0.47	16 19 20 22 24 25 28 30 32 35 38
19	08BS19	77.16	28	0.53	16 19 20 22 24 25 28 30 32 35 38
20	08BS20	81.19	28	0.60	16 19 20 22 24 25 28 30 32 35 38
21	08BS21	85.22	28	0.69	16 19 20 22 24 25 28 30 32 35 38
22	08BS22	89.24	28	0.75	16 19 20 22 24 25 28 30 32 35 38
23	08BS23	93.27	28	0.87	19 20 22 24 25 28 30 32 35 38
24	08BS24	97.29	28	0.95	19 20 22 24 25 28 30 32 35 38

* Indicates no Keyway. (2) M6 Setscrews only.
Hub diameters vary to suit different Bore Sizes.

KEYWAY IS ON CENTER LINE OF TOOTH.

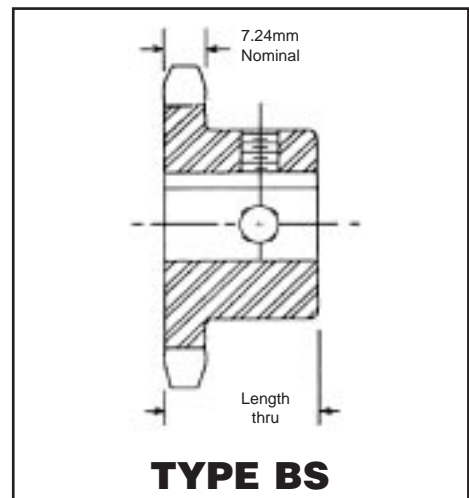

CHAIN DATA:

BS 228/11

ISO 10B-1

PITCH: 15.875mm (0.625 IN.)

ROLLER DIAMETER: 10.16mm (0.400 IN.)

ROLLER WIDTH: 9.65mm (0.380 IN.)

TENSILE: 2270 KILOS (5,000 LBS.)

#10B-1 CHAIN

15.875mm (5/8") PITCH

No. Teeth	Catalog Number	Outside Diameter (mm)	Length Thru Bore	Weight Kilos (App.)	Stock Finished Bores (mm) Includes Keyway and Setscrew
10	10BS10	41.10	25	0.14	16 19 20 22 ▼24 ▼25
11	10BS11	45.07	28	0.27	16 19 20 22 24 25 28 30
12	10BS12	49.07	28	0.32	16 19 20 22 24 25 28 30 32
13	10BS13	53.06	28	0.36	16 19 20 22 24 25 28 30 32
14	10BS14	57.07	28	0.45	16 19 20 22 24 25 28 30 32
15	10BS15	61.09	28	0.54	19 20 22 24 25 28 30 32 35
16	10BS16	65.10	30	0.66	19 20 22 24 25 28 30 32 35 38
17	10BS17	69.11	30	0.73	19 20 22 24 25 28 30 32 35 38
18	10BS18	73.14	30	0.86	19 20 22 24 25 28 30 32 35 38 40 42
19	10BS19	77.16	30	0.91	19 20 22 24 25 28 30 32 35 38 40 42
20	10BS20	81.19	30	0.95	19 20 22 24 25 28 30 32 35 38 40 42
21	10BS21	85.22	30	1.02	19 20 22 24 25 28 30 32 35 38 40 42
22	10BS22	89.24	30	1.09	19 20 22 24 25 28 30 32 35 38 40 42
23	10BS23	93.27	30	1.13	19 20 22 24 25 28 30 32 35 38 40 42
24	10BS24	97.29	30	1.36	19 20 22 24 25 28 30 32 35 38 40 42

* Keyway with Setscrew at 90
Hub diameters vary to suit different Bore Sizes.

KEYWAY IS ON CENTER LINE OF TOOTH.

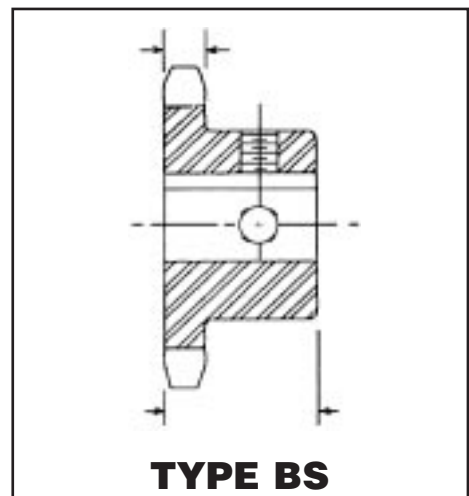

#12B

Stock Bored-to-Size



CHAIN DATA:

BS 228/13
 ISO 12B-1
 PITCH: 19.05 (0.750 IN.)
 ROLLER DIAMETER: 12.07mm (0.475 IN.)
 ROLLER WIDTH: 11.68mm (0.460 IN.)
 TENSILE: 2950 KILOS (6,500 LBS.)

#12B-1 CHAIN

19.05mm (3/4") PITCH

No. Teeth	Catalog Number	Outside Diameter (mm)	Length Thru Bore	Weight Kilos (App.)	Stock Finished Bores (mm) Includes Keyway and Setscrew
10	12BS10	61.64	30	0.32	19 20 22 24 25 28 30 32
11	12BS11	67.61	35	0.41	19 20 22 24 25 28 30 32
12	12BS12	73.61	35	0.59	19 20 22 24 25 28 30 32 35 38
13	12BS13	79.59	35	0.59	19 20 22 24 25 28 30 32 35 38
14	12BS14	85.61	35	0.73	19 20 22 24 25 28 30 32 35 38 40
15	12BS15	91.63	35	0.77	19 20 22 24 25 28 30 32 35 38 40
16	12BS16	97.65	35	0.95	19 20 22 24 25 28 30 32 35 38 40
17	12BS17	103.67	35	1.09	25 28 30 32 35 38 40 42
18	12BS18	109.71	35	1.18	25 28 30 32 35 38 40 42
19	12BS19	115.75	35	1.54	25 28 30 32 35 38 40 42 45 48 50
20	12BS20	121.78	35	1.77	25 28 30 32 35 38 40 42 45 48 50
21	12BS21	127.82	40	2.00	25 28 30 32 35 38 40 42 45 48 50
22	12BS22	133.86	40	2.13	25 28 30 32 35 38 40 42 45 48 50
23	12BS23	139.90	40	2.27	25 28 30 32 35 38 40 42 45 48 50
24	12BS24	145.94	40	2.40	25 28 30 32 35 38 40 42 45 48 50
25	12BS25	152.00	40	2.45	25 28 30 32 35 38 40 42 45 48 50

Hub diameters vary to suit different Bore Sizes.

KEYWAY IS ON CENTER LINE OF TOOTH.

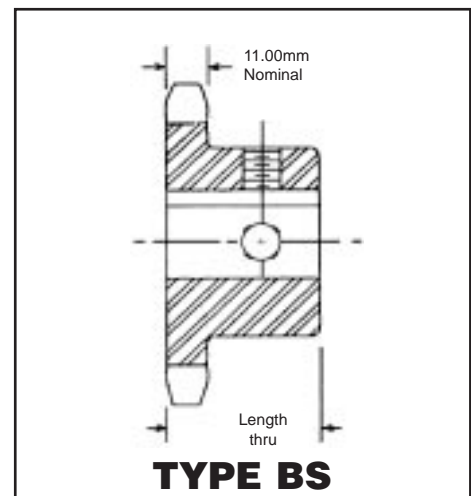

CHAIN DATA:

BS 228/15

ISO 16B-1

PITCH: 25.4mm (1.000 IN.)

ROLLER DIAMETER: 15.88mm (0.625 IN.)

ROLLER WIDTH: 17.02mm (0.670 IN.)

TENSILE: 4310 KILOS (9,500 LBS.)

#16B-1 CHAIN

25.40mm (1") PITCH

No. Teeth	Catalog Number	Outside Diameter (mm)	Length Thru Bore	Weight Kilos (App.)	Stock Finished Bores (mm) Includes Keyway and Setscrew											
11	16BS11	90.14	40	0.82	25	28	30	32	35	38	40	42				
12	16BS12	98.14	40	1.36	25	28	30	32	35	38	40	42				
13	16BS13	106.12	40	1.59	25	28	30	32	35	38	40	42	45	48	50	
14	16BS14	114.15	40	1.86	25	28	30	32	35	38	40	42	45	48	50	
15	16BS15	122.17	40	2.36	25	28	30	32	35	38	40	42	45	48	50	
16	16BS16	130.20	45	2.49	25	28	30	32	35	38	40	42	45	48	50	
17	16BS17	138.22	45	2.72	25	28	30	32	35	38	40	42	45	48	50	
18	16BS18	146.28	45	2.95	25	28	30	32	35	38	40	42	45	48	50	
19	16BS19	154.33	45	3.18	25	28	30	32	35	38	40	42	45	48	50	
20	16BS20	162.38	45	3.63	25	28	30	32	35	38	40	42	45	48	50	
21	16BS21	170.43	50	4.04	25	28	30	32	35	38	40	42	45	48	50	
22	16BS22	178.48	50	4.31	25	28	30	32	35	38	40	42	45	48	50	
23	16BS23	186.53	50	4.63	25	28	30	32	35	38	40	42	45	48	50	
24	16BS24	194.59	50	4.90	25	28	30	32	35	38	40	42	45	48	50	
25	16BS25	202.66	50	5.17	25	28	30	32	35	38	40	42	45	48	50	

Hub diameters vary to suit different Bore Sizes.

KEYWAY IS ON CENTER LINE OF TOOTH.

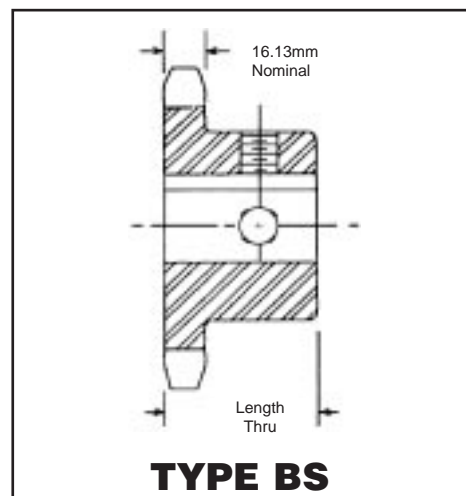

#20B

Stock Bored-to-Size



CHAIN DATA:

BS 228/17
 ISO 20B-1
 PITCH: 31.75mm (1.250 IN.)
 ROLLER DIAMETER: 19.05mm (0.750 IN.)
 ROLLER WIDTH: 19.56mm (0.770 IN.)
 TENSILE: 6580 KILOS (14,500 LBS.)

#20B-1 CHAIN

31.75mm (1-1/8") PITCH

No. Teeth	Catalog Number	Outside Diameter (mm)	Length Thru Bore	Weight Kilos (App.)	Stock Finished Bores (mm) Includes Keyway and Setscrew
9	20SB09	92.84	40	1.36	25 30 32 35 38
10	20BS10	102.74	40	1.77	25 30 32 35 38
11	20BS11	112.68	45	2.22	25 30 32 35 38 45 50 60
12	20BS12	122.68	45	2.72	25 30 32 35 38 45 50 60
13	20BS13	132.65	45	2.81	25 30 32 35 38 45 50 60
14	20BS14	142.68	45	2.99	32 35 38 45 50 60
15	20BS15	152.72	45	3.81	32 35 38 45 50 60
16	20BS16	162.75	50	4.08	38 45 50 60 65 70
17	20BS17	172.78	50	4.49	38 45 50 60 65 70
18	20BS18	182.85	50	4.81	38 45 50 60 65 70
19	20BS19	192.91	50	5.49	38 45 50 60 65 70
20	20BS20	202.98	50	5.99	38 45 50 60 65 70

Hub diameters vary to suit different Bore Sizes.

KEYWAY IS ON CENTER LINE OF TOOTH.

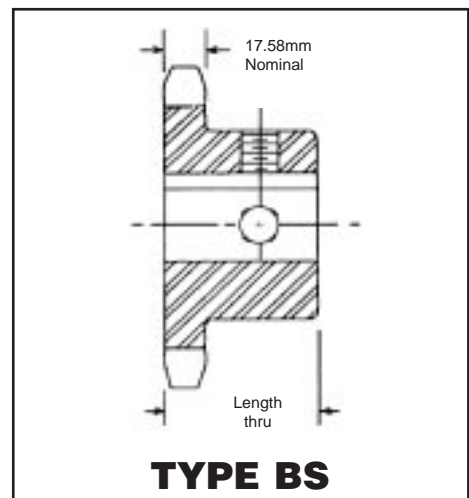

In this age of demanding deliveries and faster production methods, more and more is expected of product suppliers. In this industry, power transmission and conveying components are often subjected to shock and intermittent loads beyond normal conditions. Special made-to-order items are needed to do the job... and they're needed fast.

Martin's strategically-located manufacturing centers can produce specials to meet customer requirements as quickly as possible. We can deliver. Give *Martin* the opportunity to prove it.



Special Shear-Pin



Special Taper-Lock®



Special Split Accu-Torch®



Standard RC With Spline Bore



Multi-Strand Oil Field Sprocket with Clutch Jaws



MTO Gear Rack



Quadruple #60 Sprocket



Triple 160 Shaft Sprocket



Block Chain



Triple 200 Sprocket



Paper Mill



Special Plastic Sprocket



Double 200 Sprocket and Pinion



Special Dryer Sprocket

Martin COMPLETE
BORED-TO-SIZE LINE

FEATURES :

- Keyways on Center Line of Tooth
-(Solid and Welded)
- True Running - Pitch Diameter is
Concentric to the Bore
- High Carbon Steel - Longer Life for
Sprocket and Chain
- Heat Treatable - Without
Carburizing
- Solid and Welded Construction
- Total *Martin* Quality
- 3/8 Pitch thru 1" Pitch

Martin's new 2-Set Screw Sprocket...

- Greater holding power.
- Increased sprocket wear life.
- Reduced maintenance.
- Increased productivity.
- Keyway located on center line of tooth.
- No additional cost.
- Boxed for easy identification.
- All from the industry's quality and ser-

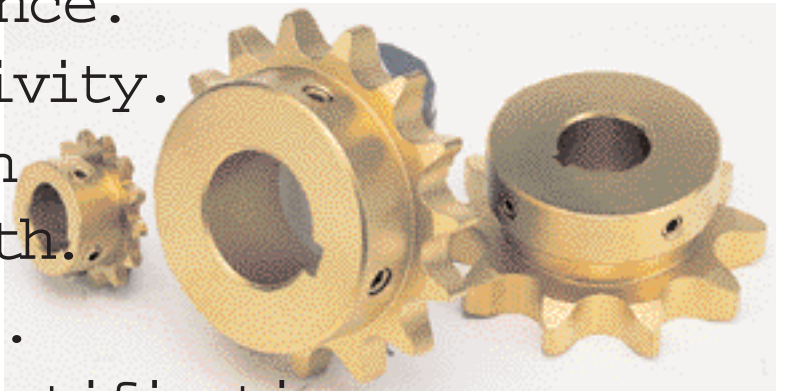

Martin's new sprocket boxing.. boxed and bar coded for simpler identification, easier handling..

- Better protection during shipping.
- Faster stocking and/or pulling of product.
- Bar coding on flap for quicker scanning.
- Easy part number



Martin... the first name in sprockets. The last word in sprocket value.

Sprockets may look alike, but...

Don't be fooled by what you see...or may not see. There are differences. Differences that can have important meaning for you.

Martin...Sprocket leader for over 45 years.

- First to introduce all steel sprocket line.
- First to introduce high carbon steel sprocket line.
- First to introduce black oxide finish sprock-

- First to offer both QD and taper-bushed line of stock sprockets.
- First American manufacturer to offer stock line of metric sprockets.
- First to offer "same day" sprocket alteration.
- First in "made-to-order" capabilities.

....And there's more to

USA

*General Offices
Sales and Manufacturing*
Arlington, TX

Sales and Manufacturing

Danielsville, PA

Ft. Worth, TX

Mansfield, TX (Conveyor Division)

Montpelier, OH

Sacramento, CA

Scottsdale, GA

Ft. Worth, TX (Tool & Forge Division)

Mini Manufacturing Centers

Boston, MA

Charlotte, NC

Chicago, IL

Denver, CO

Houston, TX

Kansas City, MO

Los Angeles, CA

Minneapolis, MN

Portland, OR

Tampa, FL

Wayne, NJ

Sold by The World's Greatest Sales People.
Our Distributors.

Martin

SPROCKET & GEAR, INC.

3100 SPROCKET DRIVE • ARLINGTON, TEXAS

76015

Manufacturing Only

Abilene, TX

Clarksville, TX

Dallas, TX

Paragould, AR (Includes the Plastics Div.)

CANADA

Sales and Manufacturing

Martin Sprocket & Gear Canada Inc.

Martin Sprocket & Gear Canada Inc.
(Conveyor Division)

CHINA

Hong Kong

Shanghai

Fuzhou

MEXICO

Sales and Manufacturing

Martin Sprocket & Gear

de Mexico, S.A. de C.V.

For more information, contact your nearest Martin Distributor or Service Center