



AK / BK
Bored-To-Size



AK / BK
MST® (Martin Split Taper) Bushed



2AK / 2BK
Bored-To-Size



2AK / 2BK
MST® (Martin Split Taper) Bushed

- Fractional horsepower sheaves for light duty applications.
- Single and double groove designs.
- Both bored-to-size and MST bushed.
- Precision machined grooves.
- Statically balanced.

Call Martin for your made-to-order and large quantity requirements.

AK Single Groove FHP Sheaves Bored-To-Size

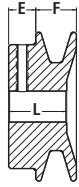

Type A
Solid

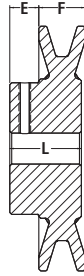

Type B
Web



Type C
Arm/Spoke

FHP Sheave — AK

Part Number	Diameter			Type	Stock Finished Bores Includes Keyway and Setscrew										F	E	L Thru Bore	Weight lb (Approx.)	
	OD	Datum A(4L) Belts	Pitch 3L Belts																
AK15	1.55	1.3	-	A	0.5	0.625									0.6563	0.4375	0.4063	0.3	
AK17	1.75	1.5	1.16	A	0.5	0.625									0.6563	0.4375	0.0625	0.3	
AK19	1.95	1.7	1.36	A	0.5	0.625	0.75	0.875							0.6563	0.4375	0.0625	0.5	
AK20	2	1.8	1.46	A	0.5	0.625	0.75								0.6563	0.4375	0.0625	0.5	
AK21	2.1	1.90	1.56	A	0.5	0.625	0.75								0.6563	0.4375	0.0625	0.5	
AK22	2.2	2	1.66	A	0.5	0.625	0.75	0.875							0.6563	0.4375	0.0625	0.6	
AK23	2.3	2.1	1.76	A	0.5	0.625	0.75								0.6563	0.4375	0.0625	0.6	
AK24	2.4	2.2	1.86	A	0.5	0.625	0.75	0.875	1						0.6563	0.4375	0.0625	0.6	
AK25	2.5	2.3	1.96	B	0.5	0.625	0.75	0.875							0.6563	0.4375	0.0625	0.7	
AK26	2.6	2.4	2.06	B	0.5	0.625	0.75								0.6563	0.4375	0.0625	0.7	
AK27	2.7	2.5	2.16	B	0.5	0.625	0.75		1						0.6563	0.4375	0.0625	0.8	
AK28	2.8	2.6	2.26	B	0.5	0.625	0.75	0.875		1					0.6563	0.4375	0.0625	0.8	
AK30	3.05	2.8	2.46	B	0.5	0.625	0.75	0.875	1						0.6563	0.4375	0.0625	0.9	
AK32	3.25	3	2.66	B	0.5	0.625	0.75	0.875	1						0.6563	0.4375	0.0625	1.0	
AK34	3.45	3.2	2.86	B	0.5	0.625	0.75	0.875	1						0.6563	0.4375	0.0625	1.1	
AK35	3.55	3.3	2.96	B	0.5	0.625	0.75	0.875	1						0.6563	0.4375	0.0625	1.2	
AK39	3.75	3.5	3.16	B	0.5	0.625	0.75	0.875	0.0625	1					0.75	0.4687	1.1563	1.6	
AK41	3.95	3.7	3.36	B	0.5	0.625	0.75	0.875	0.0625	1	1.125				0.75	0.4687	1.1563	1.6	
AK44	4.25	4	3.66	B	0.5	0.625	0.75	0.875	0.0625	1	1.125				0.75	0.4687	1.1563	1.9	
AK46	4.45	4.2	3.86	B	0.5	0.625	0.75	0.875	0.0625	1	1.125				0.75	0.4687	1.1563	2.0	
AK49	4.75	4.5	4.16	B	0.5	0.625	0.75	0.875	0.0625	1	1.125				0.75	0.4687	1.1563	2.1	
AK51	4.95	4.7	4.36	B	0.5	0.625	0.75	0.875	1	1.125					0.75	0.4687	1.1563	2.2	
AK54	5.25	5	4.66	B	0.5	0.625	0.75	0.875	0.0625	1	1.125	1.1875			0.75	0.4687	1.1563	2.4	
AK56	5.45	5.2	4.86	B	0.5	0.625	0.75	0.875	0.0625	1	1.125	1.1875			0.75	0.4687	1.1563	2.5	
AK59	5.75	5.5	5.16	C	0.5	0.625	0.75	0.875	0.0625	1	1.125	1.1875			0.75	0.4687	1.1563	2.7	
AK61	5.95	5.7	5.36	C	0.5	0.625	0.75	0.875	0.0625	1	1.125	1.1875			0.75	0.4687	1.1563	2.8	
AK64	6.25	6	5.66	C	0.5	0.625	0.75	0.875	0.0625	1	1.125	1.1875			0.75	0.4687	1.1563	3.0	
AK66	6.45	6.2	5.86	C		0.625	0.75			1	1.125				0.75	0.4687	1.1563	3.0	
AK69	6.75	6.5	6.16	C			0.75			1	1.125				0.75	0.7188	1.4687	3.7	
AK71	6.95	6.7	6.36	C	0.5	0.625	0.75			1	1.125			1.4375	0.75	0.7188	1.4687	4.3	
AK74	7.25	7	6.66	C	0.5	0.625	0.75		0.0625	1	1.125	1.1875	1.25		1.4375	0.75	0.7188*	1.4687	4.5
AK79	7.75	7.5	7.16	C			0.75			1	1.125				1.4375	0.75	0.7188	1.4687	4.7
AK81	7.95	7.7	7.36	C		0.625	0.75			1		1.1875			0.75	0.7188	1.4687	4.7	
AK84	8.25	8	7.66	C	0.5	0.625	0.75		0.0625	1		1.1875			1.4375	0.75	0.7188*	1.4687	5.0
AK89	8.75	8.5	8.16	C			0.75			1	1.125				1.4375	0.75	0.7188	1.4687	5.2
AK91	8.95	8.7	8.36	C			0.75			1					0.75	0.7188	1.4687	5.2	
AK94	9.25	9	8.66	C	0.5	0.625	0.75		0.0625	1		1.1875	1.25		1.4375	0.75	0.7188*	1.4687	5.5
AK99	9.75	9.5	9.16	C			0.75			1					1.4375	0.75	0.7188*	1.4687	5.7
AK104	10.25	10	9.66	C		0.625	0.75			1		1.1875	1.25	1.375	1.4375	0.75	0.7188	1.4687	5.9
AK109	10.75	10.5	10.16	C			0.75			1				1.375	1.4375	0.75	0.7188	1.4687	6.1
AK114	11.25	11	10.66	C			0.75			1		1.1875			1.4375	0.75	0.7188*	1.4687	6.7
AK124	12.25	12	11.66	C		0.625	0.75			1		1.1875	1.25		1.4375	0.75	0.7188*	1.4687	7.3
AK134	13.25	13	12.66	C			0.75			1		1.1875		1.375	1.4375	0.75	0.7188	1.4687	8.2
AK144	14.25	14	13.66	C			0.75			1		1.1875			1.4375	0.75	0.7188	1.4687	8.7
AK154	15.25	15	14.66	C			0.75			1					1.4375	0.75	0.7188	1.4687	9.7
AK184	18.25	18	17.66	C			0.75			1		1.1875			1.4375	0.75	0.7188	1.4687	11.8

E = 0.7813 FOR BORE SIZES <= 1
0.5" Bore - setscrew only - no keyway



Two Groove FHP Sheaves Bored-To-Size

2AK

Keyway Dimensions Inch Bore

Diameter of Shaft	Keyway Width × Depth
0.5	NONE
0.625 - 0.875	0.1875 × 0.0938
0.9375 - 1.25	0.25 × 0.125
1.3125 - 1.375	0.3125 × 0.1563
1.4375 - 1.75	0.375 × 0.1875

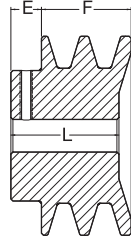

**Type A
Solid**

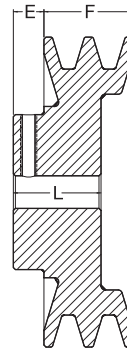

**Type B
Web**

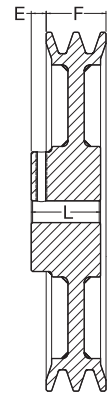

**Type C
Arm/Spoke**

FHP Sheave — 2AK

Part Number	Diameter			Type	Stock Finished Bores Includes Keyway and Setscrew										F	E	L Thru Bore	Weight lb (Approx.)
	OD	Datum A(4L) Belts	Pitch 3L Belts															
2AK20	2	1.8	1.46	A	0.5	0.625	0.75								1.375	0.4688	1.6563	0.8
2AK21	2.15	1.9	1.56	A	0.5	0.625	0.75								1.375	0.4688	1.6563	0.9
2AK22	2.25	2	1.66	A	0.5	0.625	0.75	0.875		1					1.375	0.4688	1.6563	1.1
2AK23	2.35	2.1	1.76	A		0.625	0.75	0.875		1					1.375	0.4688	1.6563	1.2
2AK25	2.55	2.3	1.96	A		0.625	0.75	0.875		1					1.375	0.4688	1.6563	1.4
2AK26	2.65	2.4	2.06	A		0.625	0.75	0.875							1.375	0.4688	1.6563	1.5
2AK27	2.75	2.5	2.16	A		0.625	0.75	0.875		1					1.375	0.4688	1.6563	1.6
2AK28	2.85	2.6	2.26	A		0.625	0.75	0.875		1					1.375	0.4688	1.6563	1.7
2AK30	3.05	2.8	2.46	A	0.5	0.625	0.75	0.875		1	1.125				1.375	0.4688	1.6563	2.0
2AK32	3.25	3	2.66	A		0.625	0.75	0.875		1	1.125				1.375	0.4688	1.6563	2.2
2AK34	3.45	3.2	2.86	A		0.625	0.75	0.875		1	1.125				1.375	0.4688	1.6563	2.5
2AK39	3.75	3.5	3.16	B		0.625	0.75	0.875		1	1.125				1.375	0.4688	1.3438	2.6
2AK41	3.95	3.7	3.36	B		0.625	0.75	0.875		1	1.125				1.375	0.4688	1.3438	2.9
2AK44	4.25	4	3.66	B		0.625	0.75	0.875		1	1.125				1.375	0.4688	1.3438	3.3
2AK46	4.45	4.2	3.86	B		0.625		0.875		1	1.125				1.375	0.4688	1.3438	3.6
2AK49	4.75	4.5	4.16	B			0.75	0.875		1	1.125		1.375		1.375	0.4688	1.3438	3.8
2AK51	4.95	4.7	4.36	B			0.75	0.875		1	1.125		1.375		1.375	0.4688	1.3438	4.1
2AK54	5.25	5	4.66	B		0.625	0.75	0.875		1	1.125		1.375		1.375	0.4688	1.3438	4.3
2AK56	5.45	5.2	4.86	B		0.625	0.75			1	1.125		1.375		1.375	0.4688	1.3438	4.5
2AK59	5.75	5.5	5.16	B						1	1.125		1.375		1.375	0.4688	1.3438	4.9
2AK61	5.95	5.7	5.36	B			0.75	0.875		1	1.125		1.375		1.375	0.4688	1.3438	5.2
2AK64	6.25	6	5.66	C			0.75			1	1.125	1.1875	1.375	1.4375	1.375	0.3438	1.5938	5.6
2AK74	7.25	7	6.66	C			0.75			1	1.125	1.1875	1.375	1.4375	1.375	0.3438	1.5938	6.5
2AK84	8.25	8	7.66	C			0.75		0.9375	1	1.125		1.375	1.4375	1.375	0.3438	1.5938	7.2
2AK94	9.25	9	8.66	C			0.75	0.875		1	1.125	1.1875	1.375	1.4375	1.375	0.3438	1.5938	8.0
2AK104	10.25	10	9.66	C			0.75		0.9375	1		1.1875		1.4375	1.375	0.3438	1.5938	9.0
2AK114	11.25	11	10.66	C						1		1.1875	1.375	1.4375	1.375	0.3438	1.5938	9.7
2AK124	12.25	12	11.66	C						1		1.1875		1.4375	1.375	0.3438	1.5938	10.5
2AK134	13.25	13	12.66	C								1.1875		1.4375	1.375	0.3438	1.5938	12.7
2AK144	14.25	14	13.66	C						1				1.4375	1.375	0.3438	1.5938	13.1
2AK154	15.25	15	14.66	C								1.1875		1.4375	1.375	0.3438	1.5938	14.3
2AK184	18.25	18	17.66	C								1.1875		1.4375	1.375	0.3438	1.5938	17.1

0.5" Bore - setscrew only - no keyway

AK-H Single Groove FHP Sheaves MST® Bushed

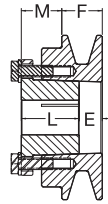

**Type A
Solid**

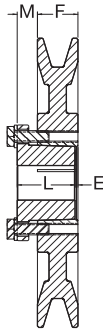

**Type B
Web**

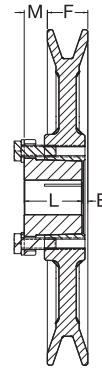

**Type C
Arm/Spoke**

FHP Sheave — AK-H

Part Number	Diameter			Type	Bush	Bush Max. Bore	F	E	L Thru Bore	M	Weight Less Bush
	OD	Datum A(4L) Belts	Pitch 3L Belts								
AK30-H	3.05	2.8	2.46	A	H	1.5	0.75	0.375	1.25	0.875	1.3
AK32-H	3.25	3	2.66	A	H	1.5	0.75	0.375	1.25	0.875	1.4
AK34-H	3.45	3.2	2.86	A	H	1.5	0.75	0.0625	1.25	0.5625	1.2
AK39-H	3.75	3.5	3.16	A	H	1.5	0.75	0.0625	1.25	0.5625	1.4
AK41-H	3.95	3.7	3.36	A	H	1.5	0.75	0.0625	1.25	0.5625	1.6
AK44-H	4.25	4	3.66	A	H	1.5	0.75	0.0625	1.25	0.5625	2.0
AK46-H	4.45	4.2	3.86	A	H	1.5	0.75	0.0625	1.25	0.5625	2.2
AK49-H	4.75	4.5	4.16	B	H	1.5	0.75	0.0625	1.25	0.5625	2.1
AK51-H	4.95	4.7	4.36	B	H	1.5	0.75	0.0625	1.25	0.5625	2.3
AK54-H	5.25	5	4.66	B	H	1.5	0.75	0.0625	1.25	0.5625	2.3
AK56-H	5.45	5.2	4.86	B	H	1.5	0.75	0.0625	1.25	0.5625	2.4
AK59-H	5.75	5.5	5.16	B	H	1.5	0.75	0.0625	1.25	0.5625	2.5
AK61-H	5.95	5.7	5.36	C	H	1.5	0.75	0.0625	1.25	0.5625	2.6
AK64-H	6.25	6	5.66	C	H	1.5	0.75	0.0625	1.25	0.5625	2.8
AK66-H	6.45	6.2	5.86	C	H	1.5	0.75	0.0625	1.25	0.5625	2.8
AK69-H	6.75	6.5	6.16	C	H	1.5	0.75	0.0625	1.25	0.5625	3.0
AK71-H	6.95	6.7	6.36	C	H	1.5	0.75	0.0625	1.25	0.5625	3.0
AK74-H	7.25	7	6.66	C	H	1.5	0.75	0.0625	1.25	0.5625	3.3
AK79-H	7.75	7.5	7.16	C	H	1.5	0.75	0.0625	1.25	0.5625	3.5
AK84-H	8.25	8	7.66	C	H	1.5	0.75	0.0625	1.25	0.5625	3.8
AK89-H	8.75	8.5	8.16	C	H	1.5	0.75	0.0625	1.25	0.5625	4.0
AK94-H	9.25	9	8.66	C	H	1.5	0.75	0.0625	1.25	0.5625	4.4
AK99-H	9.75	9.5	9.16	C	H	1.5	0.75	0.0625	1.25	0.5625	4.7
AK104-H	10.25	10	9.66	C	H	1.5	0.75	0.0625	1.25	0.5625	5.0
AK109-H	10.75	10.5	10.16	C	H	1.5	0.75	0.0625	1.25	0.5625	5.2
AK114-H	11.25	11	10.66	C	H	1.5	0.75	0.0625	1.25	0.5625	5.5
AK124-H	12.25	12	11.66	C	H	1.5	0.75	0.0625	1.25	0.5625	6.0
AK134-H	13.25	13	12.66	C	H	1.5	0.75	0.0625	1.25	0.5625	7.3
AK144-H	14.25	14	13.66	C	H	1.5	0.75	0.0625	1.25	0.5625	7.9
AK154-H	15.25	15	14.66	C	H	1.5	0.75	0.0625	1.25	0.5625	8.9
AK184-H	18.25	18	17.66	C	H	1.5	0.75	0.0625	1.25	0.5625	11.4

Dimensions in inches, weight in pounds. Weights do not include bushings. See page D-58 for additional bushing information.



Two Groove FHP Sheaves MST® Bushed

2AK-H

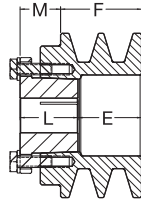

**Type A
Solid**

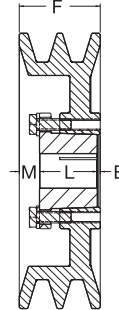

**Type B
Web**

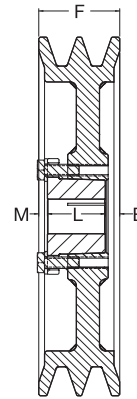

**Type C
Arm/Spoke**

FHP Sheave — 2AK-H

Part Number	Diameter			Type	Bush	Bush Max. Bore	F	E	L Thru Bore	M	Weight Less Bush
	OD	Datum A(4L) Belts	Pitch 3L Belts								
2AK30-H	3.05	2.8	2.46	A	H	1.5	1.375	1	1.25	0.875	1.7
2AK32-H	3.25	3	2.66	A	H	1.5	1.375	1	1.25	0.875	1.9
2AK34-H	3.45	3.2	2.86	A	H	1.5	1.375	0.5625	1.25	0.4375	1.7
2AK39-H	3.75	3.5	3.16	A	H	1.5	1.375	0.5625	1.25	0.4375	2.0
2AK41-H	3.95	3.7	3.36	B	H	1.5	1.375	0.0625	1.25	0.0625	2.2
2AK44-H	4.25	4	3.66	B	H	1.5	1.375	0.0625	1.25	0.0625	2.7
2AK46-H	4.45	4.2	3.86	B	H	1.5	1.375	0.0625	1.25	0.0625	3.0
2AK49-H	4.75	4.5	4.16	B	H	1.5	1.375	0.0625	1.25	0.0625	3.1
2AK51-H	4.95	4.7	4.36	B	H	1.5	1.375	0.0625	1.25	0.0625	3.5
2AK54-H	5.25	5	4.66	B	H	1.5	1.375	0.0625	1.25	0.0625	3.4
2AK56-H	5.45	5.2	4.86	B	H	1.5	1.375	0.0625	1.25	0.0625	3.6
2AK59-H	5.75	5.5	5.16	C	H	1.5	1.375	0.0625	1.25	0.0625	3.4
2AK61-H	5.95	5.7	5.36	C	H	1.5	1.375	0.0625	1.25	0.0625	3.7
2AK64-H	6.25	6	5.66	C	H	1.5	1.375	0.0625	1.25	0.0625	3.9
2AK74-H	7.25	7	6.66	C	H	1.5	1.375	0.0625	1.25	0.0625	5.0
2AK84-H	8.25	8	7.66	C	H	1.5	1.375	0.0625	1.25	0.0625	5.6
2AK94-H	9.25	9	8.66	C	H	1.5	1.375	0.0625	1.25	0.0625	6.3
2AK104-H	10.25	10	9.66	C	H	1.5	1.375	0.0625	1.25	0.0625	7.6
2AK114-H	11.25	11	10.66	C	H	1.5	1.375	0.0625	1.25	0.0625	8.4
2AK124-H	12.25	12	11.66	C	H	1.5	1.375	0.0625	1.25	0.0625	9.2
2AK134-H	13.25	13	12.66	C	H	1.5	1.375	0.0625	1.25	0.0625	11.5
2AK144-H	14.25	14	13.66	C	H	1.5	1.375	0.0625	1.25	0.0625	11.8
2AK154-H	15.25	15	14.66	C	H	1.5	1.375	0.0625	1.25	0.0625	13.3
2AK184-H	18.25	18	17.66	C	H	1.5	1.375	0.0625	1.25	0.0625	16.9

Dimensions in inches, weight in pounds. Weights do not include bushings. See page D-58 for additional bushing information.

MST "H" Bushings – Inch Bore

Diameter of Shaft	Keyway Width x Depth	Diameter of Shaft	Keyway Width x Depth	Diameter of Shaft	Keyway Width x Depth
0.375	NONE	0.7813	0.1875 x 0.0938	1.25	0.25 x 0.125
0.4375	NONE	0.8125	0.1875 x 0.0938	1.3125	0.3125 x 0.0625
0.5	0.125 x 0.0625	0.875	0.1875 x 0.0938	1.375	0.3125 x 0.0625
0.5625	0.125 x 0.0625	0.9375	0.25 x 0.125	1.375	0.375 x 0.0625
0.5938	0.125 x 0.0625	0.9688	0.25 x 0.125	1.4375	0.375 x 0.0625
0.625	0.1875 x 0.0938	1	0.25 x 0.125	1.5	0.375 x 0.03125
0.6563	0.1875 x 0.0938	1.0625	0.25 x 0.125		
0.6875	0.1875 x 0.0938	1.125	0.25 x 0.125		
0.75	0.1875 x 0.0938	1.1875	0.25 x 0.125		

MST "H" Bushings – Millimeter Bore

Diameter of Shaft	Keyway Width x Depth	Diameter of Shaft	Keyway Width x Depth
10	NONE	24	8 x 3.3
11	NONE	25	8 x 3.3
12	NONE	28	8 x 3.3
14	5 x 2.3	30	8 x 3.3
16	5 x 2.3	32	10 x 1.3
18	6 x 2.8	35	10 x 0.3
19	6 x 2.8	36	10 x 1.3
20	6 x 2.8	38	10 x 0.3
22	6 x 2.8		

BK Single Groove FHP Sheaves Bored-To-Size

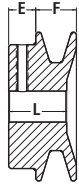

Type A
Solid

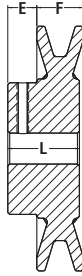

Type B
Web



Type C
Arm/Spoke

FHP Sheave — BK

Part Number	Diameter			Type	Stock Finished Bores Includes Keyway and Setscrew										F	E	L Thru Bore	Weight lb (Approx.)	
	OD	Datum A(4L) Belts	Pitch 3L Belts																
BK23	2.3	-	2.1	A		0.625				1					0.8125	0.4063	1.0625	0.4	
BK24	2.4	1.8	2.2	A	0.5	0.625	0.75	0.875							0.8125	0.4063	1.0625	0.4	
BK25	2.5	1.9	2.3	A	0.5	0.625	0.75	0.875							0.8125	0.4063	1.0625	0.5	
BK26	2.6	2	2.4	A	0.5	0.625	0.75	0.875							0.8125	0.4063	1.0625	0.6	
BK27	2.7	2.1	2.5	B	0.5	0.625	0.75	0.875			1.125				0.8125	0.4063	1.0625	0.6	
BK28	2.95	2.2	2.6	B	0.5	0.625	0.75	0.875		1	1.125				0.8125	0.4063	1.0625	0.8	
BK30	3.15	2.4	2.8	B	0.5	0.625	0.75	0.875		1	1.125				0.8125	0.4063	1.0625	0.8	
BK32	3.35	2.6	3	B	0.5	0.625	0.75	0.875		1					0.8125	0.4063	1.0625	0.8	
BK34	3.55	2.8	3.2	B	0.5	0.625	0.75	0.875		1	1.125				0.875	0.4063	1.1563	1.3	
BK36	3.75	3	3.4	B	0.5	0.625	0.75	0.875		1	1.125				0.875	0.4063	1.1563	1.5	
BK40	3.95	3.2	3.6	B	0.5	0.625	0.75	0.875		1	1.125				0.875	0.4063	1.1563	1.5	
BK45	4.25	3.5	3.9	B	0.5	0.625	0.75	0.875		1	1.125				0.875	0.4063	1.1563	1.8	
BK46	4.35	3.6	4	B				0.875							0.875	0.4063	1.1563	1.8	
BK47	4.45	3.7	4.1	B	0.5	0.625	0.75	0.875		1	1.125				0.875	0.4063	1.1563	1.8	
BK48	4.55	3.8	4.2	B	0.5	0.625	0.75	0.875			1.125				0.875	0.4063	1.1563	2.0	
BK50	4.75	4	4.4	B	0.5	0.625	0.75	0.875	0.9375	1	1.125				0.875	0.4063	1.1563	2.0	
BK52	4.95	4.2	4.6	B	0.5	0.625	0.75	0.875		1	1.125				0.875	0.4063	1.1563	2.0	
BK55	5.25	4.5	4.9	B	0.5	0.625	0.75	0.875		1	1.125	1.1875			0.875	0.4063	1.1563	2.2	
BK57	5.45	4.7	5.1	B		0.625	0.75	0.875	0.9375	1	1.125				0.875	0.4063	1.1563	2.3	
BK60	5.75	5	5.4	B	0.5	0.625	0.75	0.875		1	1.125	1.1875			0.875	0.4063	1.1563	2.3	
BK62	5.95	5.2	5.6	B	0.5	0.625	0.75	0.875	0.9375	1	1.125	1.1875			0.875	0.4063	1.1563	2.4	
BK65	6.25	5.5	5.9	B		0.625	0.75	0.875		1	1.125				0.875	0.4063	1.1563	2.7	
BK67	6.45	5.7	6.1	C		0.625	0.75	0.875		1	1.125				0.875	0.4063	1.1563	2.8	
BK70	6.75	6	6.4	C		0.625	0.75	0.875	0.9375	1	1.125	1.1875			1.4375	0.875	0.6563*	1.4688	3.3
BK72	6.95	6.2	6.6	C			0.75			1	1.125			1.375	1.4375	0.875	0.6563	1.4688	3.9
BK75	7.25	6.5	6.9	C			0.75			1	1.125				1.4375	0.875	0.6563	1.4688	3.9
BK77	7.45	6.7	7.1	C			0.75			1	1.125			1.375	1.4375	0.875	0.6563	1.4688	4.1
BK80	7.75	7	7.4	C		0.625	0.75	0.875		1	1.125	1.1875	1.25	1.375	1.4375	0.875	0.6563	1.4688	4.4
BK85	8.25	7.5	7.9	C			0.75			1	1.125	1.1875		1.375	1.4375	0.875	0.6563	1.4688	5.0
BK90	8.75	8	8.4	C			0.75	0.875	0.9375	1	1.125	1.1875		1.375	1.4375	0.875	0.6563	1.4688	5.0
BK95	9.25	8.5	8.9	C			0.75			1	1.125			1.375	1.4375	0.875	0.6563	1.4688	5.4
BK100	9.75	9	9.4	C			0.75	0.875		1	1.125	1.1875	1.25	1.375	1.4375	0.875	0.6563	1.4688	5.6
BK105	10.25	9.5	9.9	C						1				1.375	1.4375	0.875	0.6563	1.4688	5.8
BK110	10.75	10	10.4	C			0.75			1	1.125	1.1875		1.375	1.4375	0.875	0.6563	1.4688	6.4
BK115	11.25	10.5	10.9	C						1				1.375	1.4375	0.875	0.6563	1.4688	6.9
BK120	11.75	11	11.4	C			0.75			1		1.1875		1.375	1.4375	0.875	0.6563	1.4688	7.4
BK130	12.75	12	12.4	C			0.75	0.875		1	1.125	1.1875			1.4375	0.875	0.6563	1.4688	8.4
BK140	13.75	13	13.4	C			0.75			1		1.1875			1.4375	0.875	0.6563	1.4688	9.4
BK160	15.75	15	15.4	C						1	1.125	1.1875	1.25		1.4375	0.875	0.6563	1.4688	11.4
BK190	18.75	18	18.4	C						1		1.1875	1.25		1.4375	0.875	0.6563	1.4688	13.4

E = 0.4063 FOR BORE SIZES <= 1
0.5" Bore - setscrew only - no keyway



Two Groove FHP Sheaves Bored-To-Size **2BK**

Keyway Dimensions Inch Bore

Diameter of Shaft	Keyway Width × Depth
0.5	NONE
0.625 - 0.875	0.1875 × 0.0938
0.9375 - 1.25	0.25 × 0.125
1.3125 - 1.375	0.3125 × 0.1563
1.4375 - 1.75	0.375 × 0.1875

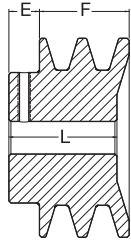

**Type A
Solid**

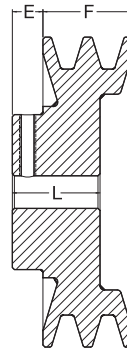

**Type B
Web**

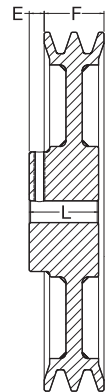

**Type C
Arm/Spoke**

FHP Sheave — 2BK

Part Number	Diameter			Type	Stock Finished Bores Includes Keyway and Setscrew								F	E	L Thru Bore	Weight lb (Approx.)	
	OD	Datum A(4L) Belts	Pitch 3L Belts														
2BK25	2.5	1.9	2.3	A	0.5	0.625	0.75	0.875						1.75	0.4688	1.9688	1.3
2BK26	2.6	2	2.4	A		0.625		0.875		1.125				1.75	0.4688	1.9688	1.5
2BK27	2.7	2.1	2.5	A	0.5	0.625	0.75	0.875	1					1.75	0.4688	1.9688	1.6
2BK28	2.95	2.2	2.6	A	0.5	0.625	0.75	0.875	1	1.125				1.75	0.4688	1.9688	1.9
2BK30	3.15	2.4	2.8	A	0.5	0.625	0.75	0.875	1	1.125				1.75	0.4688	1.9688	2.3
2BK32	3.35	2.6	3	A		0.625		0.875	1	1.125				1.75	0.4688	1.9688	2.6
2BK34	3.55	2.8	3.2	A		0.625	0.75	0.875	1	1.125				1.75	0.4688	1.9688	2.8
2BK36	3.75	3	3.4	A			0.75	0.875	1	1.125		1.375		1.75	0.4688	1.9688	3.3
2BK40	3.95	3.2	3.6	B		0.625	0.75	0.875	1	1.125				1.75	0.4688	1.4688	3.3
2BK45	4.25	3.5	3.9	B					1	1.125		1.375		1.75	0.4688	1.4688	3.3
2BK47	4.45	3.7	4.1	B				0.875	1	1.125				1.75	0.4688	1.4688	3.7
2BK50	4.75	4	4.4	B			0.75		1	1.125		1.375		1.75	0.4688	1.4688	4.1
2BK52	4.95	4.2	4.6	B				0.875	1	1.125		1.375		1.75	0.4688	1.4688	4.5
2BK55	5.25	4.5	4.9	B						1.125		1.375		1.75	0.4688	1.4688	4.5
2BK57	5.45	4.7	5.1	B					1	1.125		1.375		1.75	0.4688	1.4688	5.1
2BK60	5.75	5	5.4	B			0.75	0.875	1	1.125		1.375		1.75	0.4688	1.4688	4.9
2BK62	5.95	5.2	5.6	B					1	1.125		1.375		1.75	0.4688	1.4688	4.8
2BK65	6.25	5.5	5.9	B					1	1.125		1.375		1.75	0.4688	1.4688	5.0
2BK67	6.45	5.7	6.1	C					1	1.125		1.375		1.75	0.4688	1.4688	5.0
2BK70	6.75	6	6.4	C			0.75		1	1.125	1.1875	1.375	1.4375	1.75	0.3438	1.5938	6.6
2BK80	7.75	7	7.4	C			0.75		1	1.125	1.1875	1.375	1.4375	1.75	0.3438	1.5938	7.2
2BK90	8.75	8	8.4	C			0.75		1	1.125	1.1875	1.375	1.4375	1.75	0.3438	1.5938	8.4
2BK100	9.75	9	9.4	C			0.75		1		1.1875	1.375	1.4375	1.75	0.3438	1.5938	9.4
2BK110	10.75	10	10.4	C					1		1.1875		1.4375	1.75	0.3438	1.5938	10.4
2BK120	11.75	11	11.4	C					1		1.1875		1.4375	1.75	0.3438	1.5938	11.8
2BK130	12.75	12	12.4	C					1		1.1875		1.4375	1.75	0.3438	1.5938	14.9
2BK140	13.75	13	13.4	C					1		1.1875		1.4375	1.75	0.3438	1.5938	16.3
2BK160	15.75	15	15.4	C					1		1.1875		1.4375	1.75	0.3438	1.5938	18.0
2BK190	18.75	18	18.4	C					1		1.1875		1.4375	1.75	0.3438	1.5938	23.3

0.5" Bore - setscrew only - no keyway

BK-H Single Groove FHP Sheaves MST® Bushed

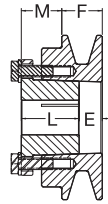

**Type A
Solid**

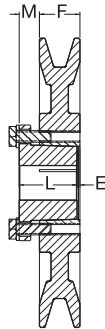

**Type B
Web**

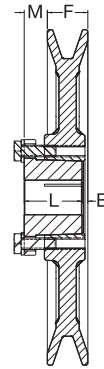

**Type C
Arm/Spoke**

FHP Sheave — BK-H

Part Number	Diameter			Type	Bush	Bush Max. Bore	F	E	L Thru Bore	M	Weight Less Bush
	OD	Datum A(4L) Belts	Pitch 3L Belts								
BK30-H	3.15	2.4	2.8	A	H	1.5	0.875	0.5	1.25	0.875	1.3
BK32-H	3.35	2.6	3	A	H	1.5	0.875	0.5	1.25	0.875	1.5
BK34-H	3.55	2.8	3.2	A	H	1.5	0.875	0.5	1.25	0.875	1.7
BK36-H	3.75	3	3.4	B	H	1.5	0.875	0.0625	1.25	0.4375	1.3
BK40-H	3.95	3.2	3.6	B	H	1.5	0.875	0.0625	1.25	0.4375	1.5
BK45-H	4.25	3.5	3.9	B	H	1.5	0.875	0.0625	1.25	0.4375	1.9
BK47-H	4.45	3.7	4.1	B	H	1.5	0.875	0.0625	1.25	0.4375	2.2
BK50-H	4.75	4	4.4	B	H	1.5	0.875	0.0625	1.25	0.4375	2.2
BK52-H	4.95	4.2	4.6	B	H	1.5	0.875	0.0625	1.25	0.4375	2.5
BK55-H	5.25	4.5	4.9	B	H	1.5	0.875	0.0625	1.25	0.4375	3.0
BK57-H	5.45	4.7	5.1	B	H	1.5	0.875	0.0625	1.25	0.4375	3.2
BK60-H	5.75	5	5.4	B	H	1.5	0.875	0.0625	1.25	0.4375	3.2
BK62-H	5.95	5.2	5.6	B	H	1.5	0.875	0.0625	1.25	0.4375	3.6
BK65-H	6.25	5.5	5.9	B	H	1.5	0.875	0.0625	1.25	0.4375	4.0
BK67-H	6.45	5.7	6.1	B	H	1.5	0.875	0.0625	1.25	0.4375	4.2
BK70-H	6.75	6	6.4	C	H	1.5	0.875	0.125	1.25	0.5	3.3
BK72-H	6.95	6.2	6.6	C	H	1.5	0.875	0.125	1.25	0.5	3.6
BK75-H	7.25	6.5	6.9	C	H	1.5	0.875	0.125	1.25	0.5	3.4
BK77-H	7.45	6.7	7.1	C	H	1.5	0.875	0.125	1.25	0.5	3.7
BK80-H	7.75	7	7.4	C	H	1.5	0.875	0.125	1.25	0.5	4.0
BK85-H	8.25	7.5	7.9	C	H	1.5	0.875	0.125	1.25	0.5	4.1
BK90-H	8.75	8	8.4	C	H	1.5	0.875	0.125	1.25	0.5	4.5
BK95-H	9.25	8.5	8.9	C	H	1.5	0.875	0.125	1.25	0.5	4.8
BK100-H	9.75	9	9.4	C	H	1.5	0.875	0.125	1.25	0.5	5.1
BK105-H	10.25	9.5	9.9	C	H	1.5	0.875	0.125	1.25	0.5	5.4
BK110-H	10.75	10	10.4	C	H	1.5	0.875	0.125	1.25	0.5	6.0
BK115-H	11.25	10.5	10.9	C	H	1.5	0.875	0.125	1.25	0.5	6.3
BK120-H	11.75	11	11.4	C	H	1.5	0.875	0.125	1.25	0.5	6.6
BK130-H	12.75	12	12.4	C	H	1.5	0.875	0.125	1.25	0.5	7.2
BK140-H	13.75	13	13.4	C	H	1.5	0.875	0.125	1.25	0.5	8.6
BK150-H	14.75	14	14.4	C	H	1.5	0.875	0.125	1.25	0.5	9.4
BK160-H	15.75	15	15.4	C	H	1.5	0.875	0.125	1.25	0.5	10.1
BK190-H	18.75	18	18.4	C	H	1.5	0.875	0.125	1.25	0.5	12.3

Dimensions in inches, weight in pounds. Weights do not include bushings. See page D-58 for additional bushing information.



Two Groove FHP Sheaves MST® Bushed **2BK-H**

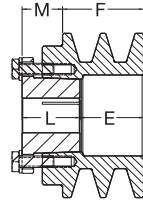

Type A
Solid

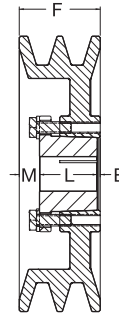

Type B
Web

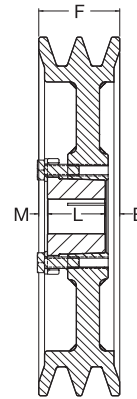

Type C
Arm/Spoke

FHP Sheave — 2BK-H

Part Number	Diameter			Type	Bush	Bush Max. Bore	F	E	L Thru Bore	M	Weight Less Bush
	OD	Datum A(4L) Belts	Pitch 3L Belts								
2BK32-H	3.35	2.6	3	A	H	1.5	1.75	1.375	1.25	0.875	2.2
2BK34-H	3.55	2.8	3.2	A	H	1.5	1.75	1.375	1.25	0.875	2.6
2BK36-H	3.75	3	3.4	A	H	1.5	1.75	0.9375	1.25	0.4375	2.4
2BK40-H	3.95	3.2	3.6	A	H	1.5	1.75	0.9375	1.25	0.4375	2.6
2BK45-H	4.25	3.5	3.9	A	H	1.5	1.75	0.9375	1.25	0.4375	3.1
2BK47-H	4.45	3.7	4.1	B	H	1.5	1.75	0.0625	1.25	0.4375	3.2
2BK50-H	4.75	4	4.4	B	H	1.5	1.75	0.0625	1.25	0.4375	3.7
2BK52-H	4.95	4.2	4.6	B	H	1.5	1.75	0.0625	1.25	0.4375	4.1
2BK55-H	5.25	4.5	4.9	B	H	1.5	1.75	0.0625	1.25	0.4375	4.2
2BK57-H	5.45	4.7	5.1	B	H	1.5	1.75	0.0625	1.25	0.4375	4.5
2BK60-H	5.75	5	5.4	B	H	1.5	1.75	0.0625	1.25	0.4375	4.9
2BK62-H	5.95	5.2	5.6	B	H	1.5	1.75	0.0625	1.25	0.4375	5.2
2BK65-H	6.25	5.5	5.9	C	H	1.5	1.75	0.3125	1.25	0.1875	5.7
2BK67-H	6.45	5.7	6.1	C	H	1.5	1.75	0.3125	1.25	0.1875	5.8
2BK70-H	6.75	6	6.4	C	H	1.5	1.75	0.3125	1.25	0.1875	6.1
2BK72-H	6.95	6.2	6.6	C	H	1.5	1.75	0.3125	1.25	0.1875	6.1
2BK80-H	7.75	7	7.4	C	H	1.5	1.75	0.3125	1.25	0.1875	7.4
2BK90-H	8.75	8	8.4	C	H	1.5	1.75	0.3125	1.25	0.1875	8.5
2BK100-H	9.75	9	9.4	C	H	1.5	1.75	0.3125	1.25	0.1875	9.7
2BK110-H	10.75	10	10.4	C	H	1.5	1.75	0.3125	1.25	0.1875	10.9
2BK120-H	11.75	11	11.4	C	H	1.5	1.75	0.3125	1.25	0.1875	12.0
2BK130-H	12.75	12	12.4	C	H	1.5	1.75	0.3125	1.25	0.1875	13.4
2BK140-H	13.75	13	13.4	C	H	1.5	1.75	0.3125	1.25	0.1875	15.3
2BK160-H	15.75	15	15.4	C	H	1.5	1.75	0.3125	1.25	0.1875	17.8
2BK190-H	18.75	18	18.4	C	H	1.5	1.75	0.3125	1.25	0.1875	22.8

Dimensions in inches, weight in pounds. Weights do not include bushings. See page D-58 for additional bushing information.

MST "H" Bushings – Inch Bore

Diameter of Shaft	Keyway Width x Depth	Diameter of Shaft	Keyway Width x Depth	Diameter of Shaft	Keyway Width x Depth
0.375	NONE	0.7813	0.1875 x 0.0938	1.25	0.25 x 0.125
0.4375	NONE	0.8125	0.1875 x 0.0938	1.3125	0.3125 x 0.0625
0.5	0.125 x 0.0625	0.875	0.1875 x 0.0938	1.375	0.3125 x 0.0625
0.5625	0.125 x 0.0625	0.9375	0.25 x 0.125	1.375	0.375 x 0.0625
0.5938	0.125 x 0.0625	0.9688	0.25 x 0.125	1.4375	0.375 x 0.0625
0.625	0.1875 x 0.0938	1	0.25 x 0.125	1.5	0.375 x 0.0313
0.6563	0.1875 x 0.0938	1.0625	0.25 x 0.125		
0.6875	0.1875 x 0.0938	1.125	0.25 x 0.125		
0.75	0.1875 x 0.0938	1.1875	0.25 x 0.125		

MST "H" Bushings – Millimeter Bore

Diameter of Shaft	Keyway Width x Depth	Diameter of Shaft	Keyway Width x Depth
10	NONE	24	8 x 3.3
11	NONE	25	8 x 3.3
12	NONE	28	8 x 3.3
14	5 x 2.3	30	8 x 3.3
16	5 x 2.3	32	10 x 1.3
18	6 x 2.8	35	10 x 0.3
19	6 x 2.8	36	10 x 1.3
20	6 x 2.8	38	10 x 0.3
22	6 x 2.8		